

WH9011A-1-18T

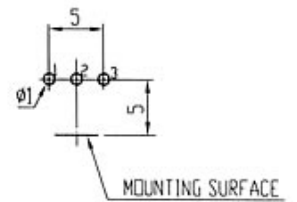

SHAFT SHOWN IN
FULL C.C.W. POSITION

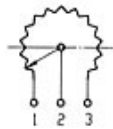
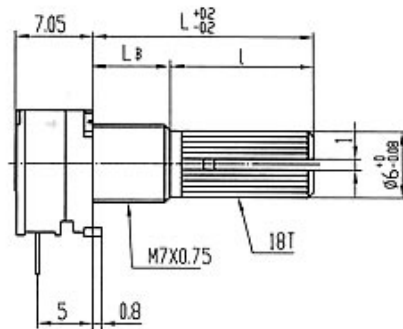
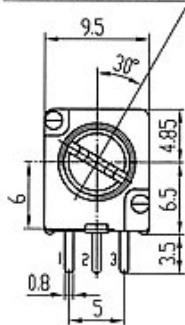

WH9011AK-1-18T



SHAFT SHOWN IN
FULL C.C.W. POSITION

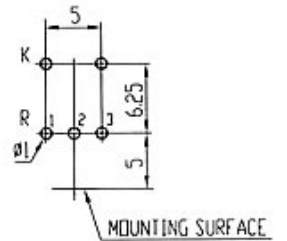
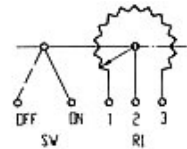
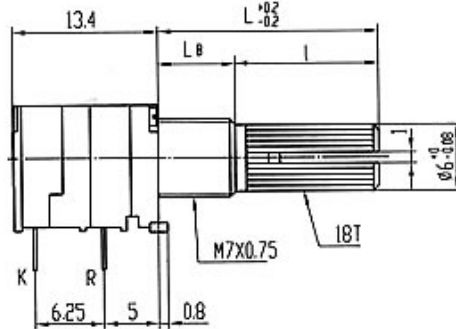
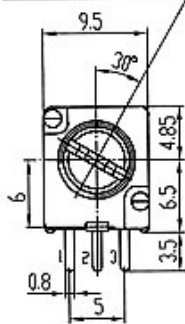

阻值范围 Resistance range	5~250K Ω	总机械旋转角度 Total Rotational Angle	300 \pm 5 $^{\circ}$
阻值允许误差 Tolerance of resistance	\pm 20%	动作力 Operating force	50~250gf.cm
电值规律 Resistance taper	A B C D	定位点起动力 Click slip-out force (only center click)	\pm 30~100gf.cm
额定功率 power Rating	0.05W	止挡强度 Shaft Stopper Strength	4Kgf.cm min
额定电压 Rated voltage	50V AC	开关额定功率 Switch Rating	DC16V 1A
终端电阻 Terminal resistance	10 Ω max	开关操作力 Switch Action	50~300gf.cm
转动噪声 Rotational noise	\leq 100mv	开关动作角度 Switch Working Angle	\leq 50 $^{\circ}$
双联同步误差 Tracking error	B 0~20db \pm 2db A C D 0~40db \pm 3db	开关接触电阻 Switch contact resistance	\leq 50m Ω
绝缘电阻 Insulation resistance	DC250V 100M Ω min	机械耐久性 Mechanical endurance	10000周min turns
耐电压 Withstanding Voltage	AC300V 1 minute	开关寿命 Switch life	10000周min

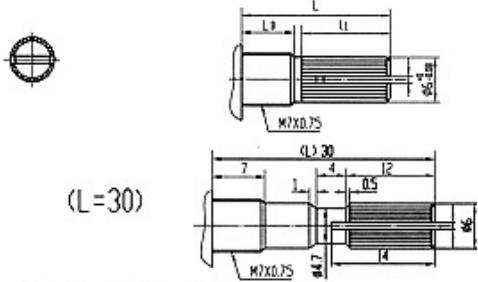
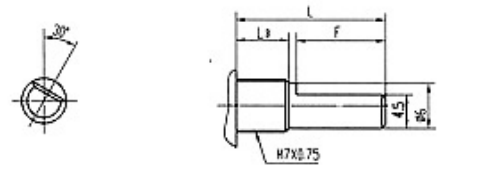
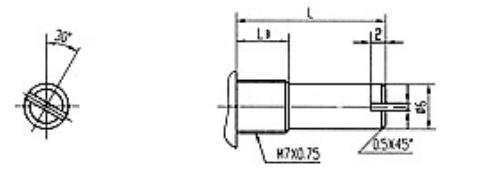
<p>●18T</p>  <p>(L=30)</p>	<table border="1"> <thead> <tr> <th>L</th> <th>L^B</th> <th>L¹</th> </tr> </thead> <tbody> <tr> <td rowspan="2">15</td> <td>5</td> <td>7</td> </tr> <tr> <td>7</td> <td>7</td> </tr> <tr> <td rowspan="2">20</td> <td>5</td> <td>12</td> </tr> <tr> <td>7</td> <td>12</td> </tr> <tr> <td>25</td> <td>7</td> <td>17</td> </tr> </tbody> </table>	L	L ^B	L ¹	15	5	7	7	7	20	5	12	7	12	25	7	17	
L	L ^B	L ¹																
15	5	7																
	7	7																
20	5	12																
	7	12																
25	7	17																
<p>●F</p> 	<table border="1"> <thead> <tr> <th>L</th> <th>L^B</th> <th>F</th> </tr> </thead> <tbody> <tr> <td rowspan="2">15</td> <td>5</td> <td>7</td> </tr> <tr> <td>7</td> <td>7</td> </tr> <tr> <td>20</td> <td>7</td> <td>12</td> </tr> <tr> <td>25</td> <td>7</td> <td>12</td> </tr> <tr> <td>30</td> <td>7</td> <td>12</td> </tr> </tbody> </table>	L	L ^B	F	15	5	7	7	7	20	7	12	25	7	12	30	7	12
L	L ^B	F																
15	5	7																
	7	7																
20	7	12																
25	7	12																
30	7	12																
<p>●H</p> 	<table border="1"> <thead> <tr> <th>L</th> <th>L^B</th> </tr> </thead> <tbody> <tr> <td>8</td> <td>5</td> </tr> <tr> <td>10</td> <td>5</td> </tr> <tr> <td>13</td> <td>5</td> </tr> <tr> <td>15</td> <td>5</td> </tr> <tr> <td>20</td> <td>7</td> </tr> </tbody> </table>	L	L ^B	8	5	10	5	13	5	15	5	20	7					
L	L ^B																	
8	5																	
10	5																	
13	5																	
15	5																	
20	7																	