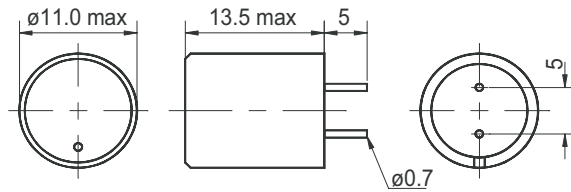

TYPE 11RHBP
Inductance Range: 10~560 μ H

(Unit: mm)

FEATURES / 特徴

Closed magnetic circuit construction and low leakage flux type.

Suitable for large current.

Ideal for use as chokes for high current DC-DC circuits in all types of electronic instruments.

Lead-free.

閉磁路構造、低漏れ磁束タイプ

大電流対応

各種電子機器の大電流回路用チョークに最適

鉛フリー

TYPE 11RHBP

TOKO Part Number	Inductance L (μ H)	Tolerance (%)	DC Resistance () max.	Rated DC Current (A) max.
A7503CY-100M	10	± 20	0.030	3.46
A7503CY-150M	15	± 20	0.038	2.57
A7503CY-180M	18	± 20	0.042	2.37
A7503CY-220M	22	± 20	0.045	2.21
A7503CY-270M	27	± 20	0.054	1.95
A7503CY-330M	33	± 20	0.057	1.83
A7503CY-390M	39	± 20	0.082	1.62
A7503CY-470M	47	± 20	0.090	1.60
A7503CY-560M	56	± 20	0.095	1.40
A7503CY-680M	68	± 20	0.150	1.36
A7503CY-820M	82	± 20	0.153	1.16
A7503CY-101M	100	± 20	0.210	1.10
A7503CY-121M	120	± 20	0.221	0.95
A7503CY-151M	150	± 20	0.242	0.86
A7503CY-181M	180	± 20	0.273	0.76
A7503CY-221M	220	± 20	0.360	0.74
A7503CY-271M	270	± 20	0.380	0.63
A7503CY-331M	330	± 20	0.430	0.57
A7503CY-391M	390	± 20	0.600	0.51
A7503CY-471M	470	± 20	0.810	0.48
A7503CY-561M	560	± 20	0.891	0.43

 (1) Inductance is measured at $f=1\text{kHz}$, $V_{osc}=1\text{V}$ on LCR meter HP4284A or equivalent.

(2) The rated DC current is that which the inductance value decreases 10% by the excitation of DC current.

(3) DC resistance is measured with Digital Multimeter TR6871(Advantest) or equivalent.

CAUTION / お断り

1. Please be sure that you carefully discuss your planned purchase with our sales division if you intend to use the products in this catalog for applications where extremely high reliability is required or if you intend to use products for applications other than those listed in this catalog.

2. Note that the contents of this catalog are subject to change without notice. When placing your order, please confirm the specifications and delivery conditions.

1. このカタログの記載の製品について、極めて高い信頼性が要求される用途での使用をご検討の場合、またはこのカタログに記載された用途以外での使用をご検討の場合は、必ず事前に当社営業窓口までご相談ください。

2. 記載内容を予告なく変更することがありますのでご了承ください。ご注文に際しては仕様・納入仕様書などの取り交わしをお願いします。