

Type 001

Screw type terminal block, solderable, centerline 5 mm / 0.197 inches, horizontal wire entry, wire protector

Technical Data

UL V / A / AWG 300 / 15 / 22 - 14

SP V / A / AWG 300 / 15 / 22 - 14

S 0.33 - 1.5 mm² 125 V / 2.5 kV / 13 A

Insulation co-ordination according to EN 60664-1

Clearance and creepage distances min. 2.6 mm

Insulating material class CTI 600

Overvoltage category III III II

Pollution degree 3 2 2

Rated voltage [V] 200 500 500

Rated test voltage [kV] 2.5 4 2.5

Protection category according to IEC 60529 IP00

Tightening torque UL 7 lb-in max.

Min. insul. strip length 6 mm

Solder pin dimension Ø 0.9 mm

Recommended pc board hole dia. Ø 1.3 mm

Solder pin length 3.8 mm

Pole size 2 - 22

Colour grey

Type 055

Screw type terminal block, solderable, centerline 5 mm / 0.197 inches, horizontal wire entry, wire protector, modular

Technical Data

UL V / A / AWG 300 / 15 / 22 - 14

SP V / A / AWG 300 / 15 / 22 - 14

S 0.33 - 1.5 mm² 125 V / 2.5 kV / 13 A

Insulation co-ordination according to EN 60664-1

Clearance and creepage distances min. 2.6 mm

Insulating material class CTI 600

Overvoltage category III III II

Pollution degree 3 2 2

Rated voltage [V] 200 500 500

Rated test voltage [kV] 2.5 4 2.5

Protection category according to IEC 60529 IP00

Tightening torque UL 7 lb-in max.

Min. insul. strip length 6 mm

Solder pin dimension Ø 0.9 mm

Recommended pc board hole dia. Ø 1.3 mm

Solder pin length 3.8 mm

Pole size 2 - 4

Colour grey

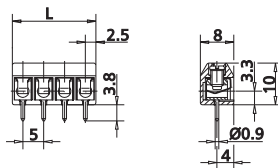

$L = (\text{pole size} - 1) \times \text{centerline} + 5 \text{ mm}$

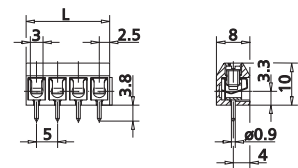

$L = (\text{pole size} - 1) \times \text{centerline} + 5 \text{ mm}$

Part numbers (P/N)

(informations: page 54)

Complete the part number by adding the pole size.

Type 001 centerline 5 mm

P/N 310011

| | | | | | | | |
|----|----|----|----|----|----|----|----|
| | 02 | 03 | 04 | 05 | 06 | 07 | 08 |
| 09 | 10 | 11 | 12 | 13 | 14 | 15 | 16 |
| 17 | 18 | 19 | 20 | 21 | 22 | | |

Type 001 centerline 10 mm

P/N 310012

| | | | | | | | |
|----|----|----|----|----|----|----|----|
| | 02 | 03 | 04 | 05 | 06 | 07 | 08 |
| 09 | 10 | 11 | | | | | |
| | | | | | | | |

Standard pole sizes

Available on demand. Minimum order quantity 5000 poles per item.

Part numbers (P/N)

(informations: page 54)

Complete the part number by adding the pole size.

Type 055 centerline 5 mm

P/N 310551

| | | | | | | | |
|--|----|----|----|--|--|--|--|
| | 02 | 03 | 04 | | | | |
| | | | | | | | |
| | | | | | | | |

Standard pole sizes

Available on demand. Minimum order quantity 5000 poles per item.