

FEATURES AND SPECIFICATIONS

Features and Benefits

- Box-style contact design provides protection and secure mating force
- Locking tang latches into housing window

Reference Information

Packaging: Reel or bag (see Table)
 Use With: [51146](#)
 Designed In: Millimeters

Electrical

Voltage: 125V
 Current: 1.0A
 Contact Resistance: 20mΩ max.
 Dielectric Withstanding Voltage: 250V AC
 Insulation Resistance: 100 MΩ min.

Physical

Contact: Phosphor Bronze
 Plating: Gold over Nickel
 Wire Range: 28 to 32 AWG
 Insulation Diameter:
 50753—0.40 to 0.55mm (.016 to .022") max.
 50641—0.50 to 0.90mm (.020 to .035") max.
 Strip Length: 1.3 to 1.7mm



1.25mm (.049") Pitch PanelMate™ Wire-To-Board Crimp Terminal

50641/50753

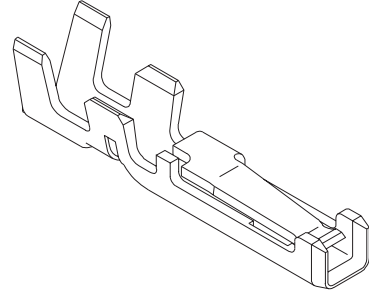

A 0.40 to 1.60mm (.016 to .063") Pitch

CATALOG DRAWING (FOR REFERENCE ONLY)

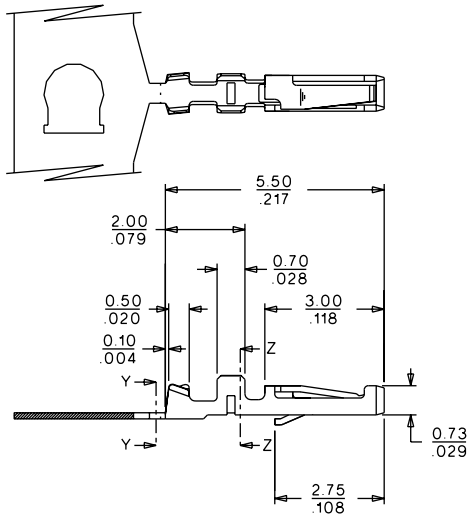

50753

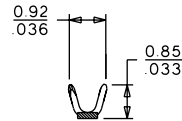

SECTION Y-Y

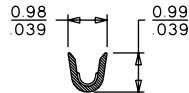

SECTION Z-Z

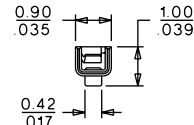

50641

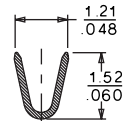

SECTION Y-Y

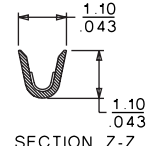

SECTION Z-Z

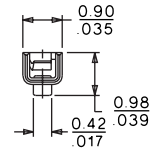

ORDERING INFORMATION

Order No.	Packaging	Wire Gauge
50641-8041	Reel	28 to 30 AWG
50641-8141	Bag	28 to 30 AWG
50753-8041	Reel	30 to 32 AWG
50753-8141	Bag	30 to 32 AWG