

FEATURES AND SPECIFICATIONS

Features and Benefits

- Pre-loaded upper housing offers precise cover-to-base alignment, ensuring a reliable termination
- Early-entry single-beam contact provides long wiping action during mating
- Optional polarization and locking ramp
- Optional strain relief is available

Reference Information

Product Specification: PS-87568-004
 Packaging: Tray
 Wire Style: UL2651, UL2678
 UL File No.: E29179
 CSA File No.: LR19980
 Mates With: Milli-Grid 2.00mm (.079") Headers
 Use With: [87569](#) Strain Relief
 Designed In: Millimeters

Electrical

Voltage: 125V DC
 Current: 1.0A
 Contact Resistance: 30mΩ max.
 Dielectric Withstanding Voltage: 500V AC
 Insulation Resistance: 5000 MΩ min.

Mechanical

Contact Retention to Housing: 1.96N (0.44 lb) max.
 Wire Pull-Out Force: 2.45N (0.55 lb) max.
 Mating Force: 1.96N (0.44 lb) max.
 Unmating Force: 0.39N (0.09 lb) min.
 Durability: 600 cycles max.

Physical

Housing: High Thermoplastic, UL 94V-0
 Contact: Copper Alloy
 Plating: Contact Area—See Table Below
 Underplating—Nickel
 Operating Temperature: -20 to +85°C
 Cable: 1.00mm Flat Cable, 7 Strands, 28 AWG



2.00mm (.079") Pitch Milli-Grid™ Cable-to-Board Receptacle

87568

Dual Row, IDT

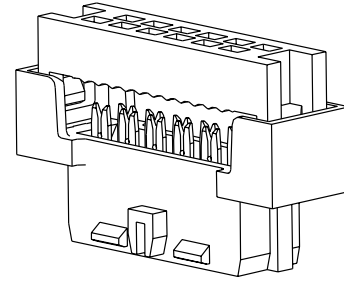

B

2.00 to 2.50mm (.079 to .098") Pitch

CATALOG DRAWING (FOR REFERENCE ONLY)

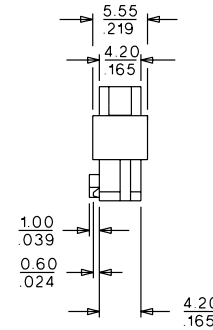
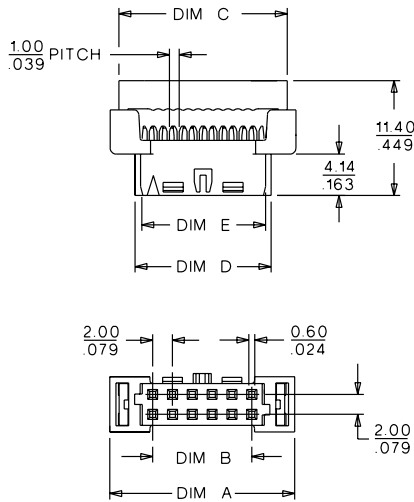

ORDERING INFORMATION AND DIMENSIONS

Circuits	Order No.		Dimension				
	0.38μm (15μ") Gold	0.76μm (30μ") Gold	A	B	C	D	E
10	87568-10X1	87568-10X2	16.65 (.660)	8.00 (.310)	14.90 (.590)	11.65 (.460)	10.55 (.420)
12	87568-12X1	87568-12X2	18.65 (.730)	10.00 (.390)	16.90 (.670)	13.65 (.540)	12.55 (.490)
14	87568-14X1	87568-14X2	20.65 (.810)	12.00 (.470)	18.90 (.740)	15.65 (.620)	14.55 (.570)
16	87568-16X1	87568-16X2	22.65 (.890)	14.00 (.550)	20.90 (.820)	17.65 (.690)	16.55 (.650)
20	87568-20X1	87568-20X2	26.65 (1.050)	18.00 (.710)	24.90 (.980)	21.65 (.850)	20.55 (.810)
22	87568-22X1	87568-22X2	28.65 (1.130)	20.00 (.790)	26.90 (1.060)	23.65 (.930)	22.55 (.890)
24	87568-24X1	87568-24X2	30.65 (1.210)	22.00 (.870)	28.90 (1.140)	25.65 (1.010)	24.55 (.970)
26	87568-26X1	87568-26X2	32.65 (1.290)	24.00 (.940)	30.90 (1.220)	27.65 (1.090)	26.55 (1.050)
30	87568-30X1	87568-30X2	36.65 (1.440)	28.00 (1.100)	34.90 (1.370)	31.65 (1.250)	30.55 (1.200)
34	87568-34X1	87568-34X2	40.65 (1.600)	32.00 (1.260)	38.90 (1.530)	35.65 (1.400)	34.55 (1.360)
40	87568-40X1	87568-40X2	46.65 (1.840)	38.00 (1.500)	44.90 (1.770)	41.65 (1.640)	40.55 (1.600)
44	87568-44X1	87568-44X2	50.65 (1.990)	42.00 (1.650)	48.90 (1.930)	45.65 (1.800)	44.55 (1.750)
50	87568-50X1	87568-50X2	56.65 (2.230)	48.00 (1.890)	54.90 (2.160)	61.65 (2.430)	50.55 (1.990)

Circuits	X=4 With Center Polarization	X=6 Without Polarization and Locking Ramp	X=7 With Single Locking Ramp	X=9 With Polarization and Locking Ramp
10	No	Yes	Yes	No
12	No	Yes	Yes	No
14	Yes	Yes	No	Yes
16	Yes	Yes	No	Yes
20	Yes	Yes	No	Yes
22	Yes	Yes	No	Yes
24	Yes	Yes	No	Yes
26	Yes	Yes	No	Yes
30	Yes	Yes	No	Yes
34	Yes	Yes	No	Yes
40	Yes	Yes	No	Yes
44	Yes	Yes	No	Yes
50	Yes	Yes	No	Yes