

5 4 3 2 1

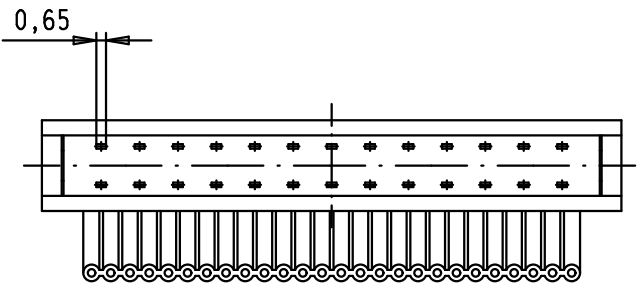

PCB layout, component side

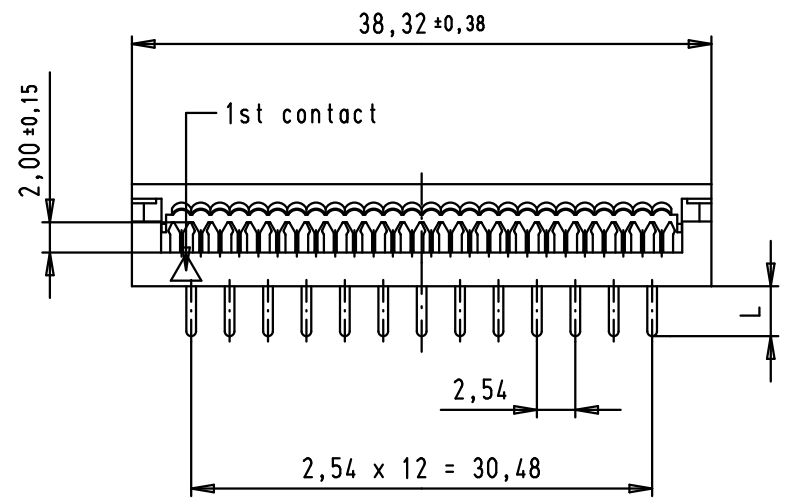
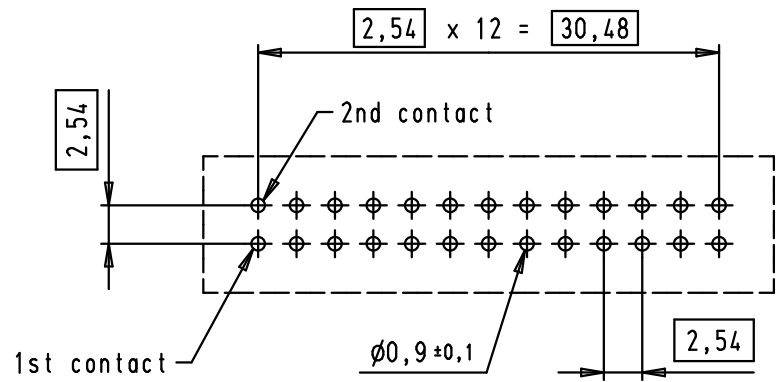

PRE-ASSEMBLED

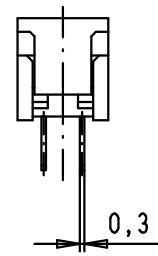

ASSEMBLED

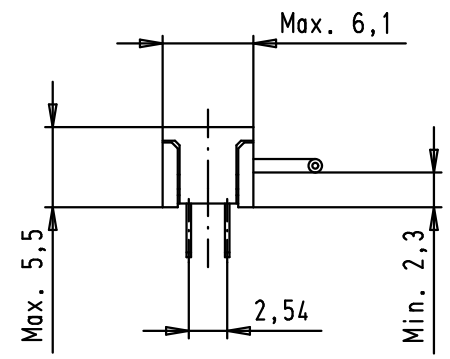

09 18 126 9622.210	3,0 ⁰ _{-0,25}	PRE-ASSEMBLED
09 18 126 9622.200	3,3 ^{±0,25}	NON ASSEMBLED
09 18 126 9622	3,3 ^{±0,25}	PRE-ASSEMBLED
Part number	L	COVER

			Dat.	Name	
			Detail.	02/04/04	JH
			Insp.		
			Stand.		
34919	30/05/08	PK			
34889	08/04/08	PK			
31884	02/04/04	JH			
Mod.	Dat.	Name			

HARTING EURL
F-95972 Paris



SEK 18, low profile,
PCB transition,
26 poles, 2 rows

TB 09 18 126 9622

Maßstab/
Scale
2:1
Blatt/ Page
1 / 1