

Quartz Crystal

SMD-version

| | |
|--|--|
| model | KX – 8 |
| frequency range | 12,0 ~ 60,0 MHz |
| mode | fundamental |
| operating temperature | standard -20° ~ + 70°C available -40° ~ + 85°C (=KX-8T) available -40° ~ +105°C (=KX-8E) |
| frequency tolerance at +25°C | standard ± 30 ppm available ± 10 ~ ± 50 ppm |
| temperature tolerance -20° ~ + 70°C -40° ~ + 85°C -40° ~ +105°C | standard ± 50 ppm, available ±10 ~ ±50 ppm standard ±100 ppm, available ±20 ~ ± 100 ppm standard ±120 ppm, available ±30 ~ ± 120 ppm |
| load capacitance C_L | standard 16 pF available 10 ~ 20 pF |
| series resonance R_1 max. | 12,0 ~ 29,99 MHz 80 Ohm 30,0 ~ 60,0 MHz 50 Ohm |
| aging (first year) | ± 5 ppm |
| shunt capacitance C_O max. | 5,0 pF |
| drive level in mW max. | 0,05 |
| RoHS | since production start |
| contents of reel | 1000 pcs. |
| part no. | 12.88800 ~ 12.88999 |

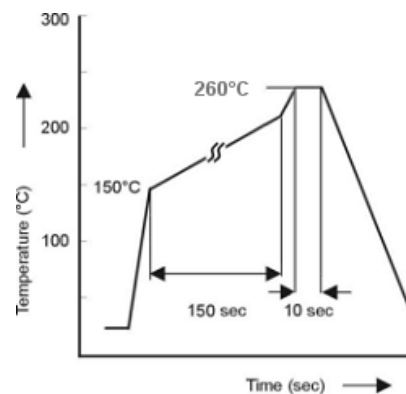
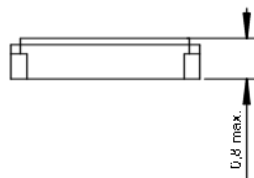
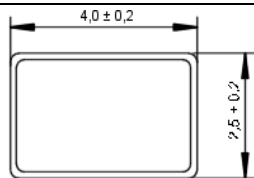

soldering condition

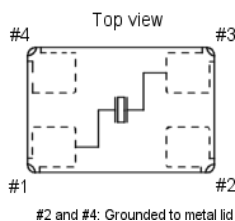
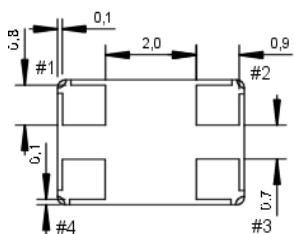

#2 and #4: Grounded to metal lid

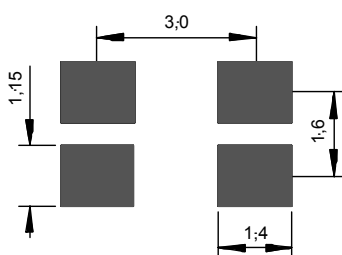

suggested soldering pads

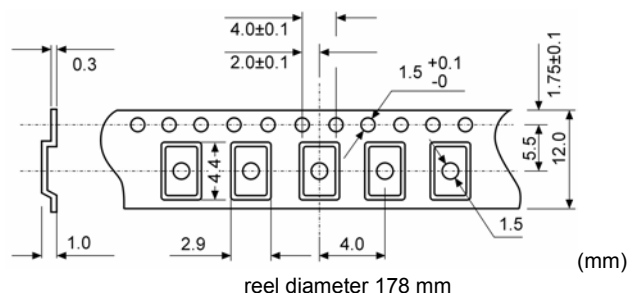

reel diameter 178 mm

(mm)