

SPECIFICATION

MODEL : DW 9704

1. Sensing Area : 1/3" CCD, 1/4" CCD
2. Focal Length : 3.6mm
3. Back Focal Length : 5.7mm
4. F NO. : 2.0
5. Iris : Fixed
6. Optical Distortion : 1/3" : -27% , 1/4" : -15.2%
7. Lens Construction : 4 Components 4 Elements
8. Angle Of View : 1/3" 95.4°(D), 74.1°(H), 54.8°(V)
(7% Over Scan) 1/4" 68.6°(D), 54.2°(H), 40.2°(V)
9. Focus Extent : 40cm - ∞
10. Weight : 5.5g

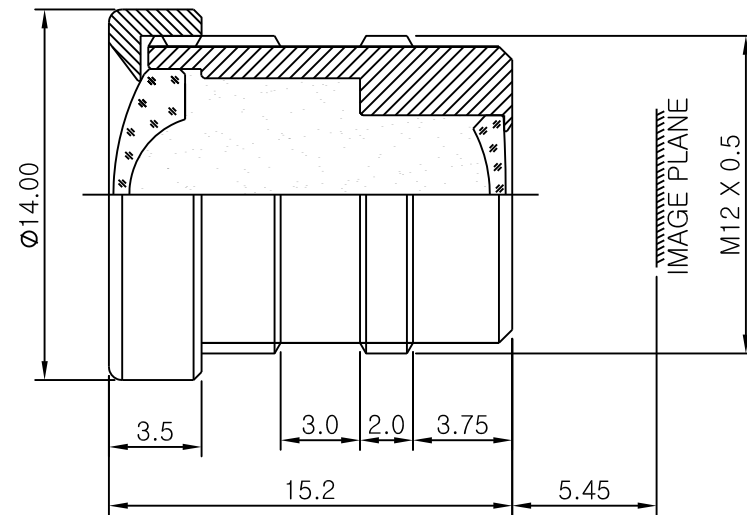

Tolerance : ± 0.4 mm

DAIWON OPTICAL CO., LTD.