

## CB39 Series Single Row Female Header

2.54mm(.100") Center spacing

☉ Mates with CH31 and CH34

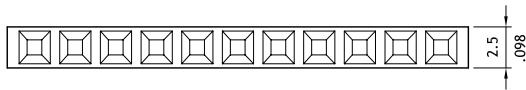
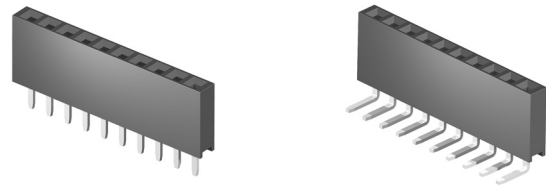

A = 2.54 \* No. of Spaces  
B = A + 3.0

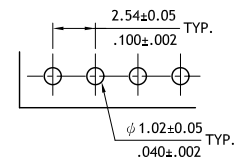
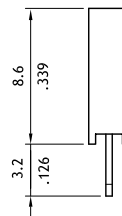
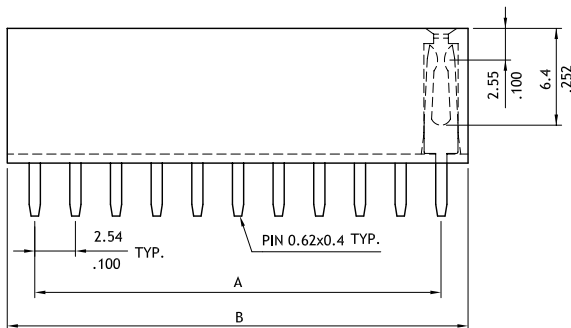

Recommended P.C. Board Layout

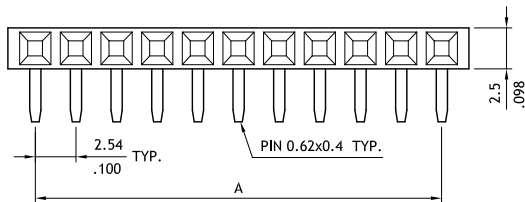

A = 2.54 \* No. of Spaces  
B = A + 3.0

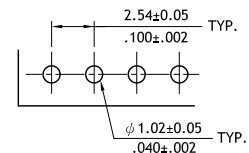
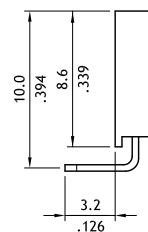
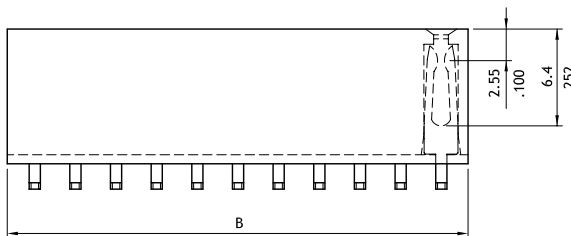

Recommended P.C. Board Layout

### Ordering Code

**1**      **2**      **3**      **4**      **5**      **6**  
**CB 3 9**    **4 0**    **2**    **V**    **1**    **0 0**

**1** Series No.  
**2** Circuits:  
02 to 40

**3** Plating code:  
2=Gold flash over Nickel plated  
\*Optional plating available but MOQ requested

**4** Tail Style:  
V=Straight  
H=Right Angle

**5** Color:1=Black

**6** Other options:  
00=Standard  
\*Special options consult manufacturer