

# CH57 Series 1.27mm(.050") Dual Row Dual Body Pin Headers

- Mates with CB50, CBC1
- Lead Free soldering process available

**RoHS** Compliant

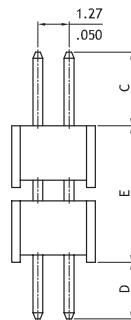
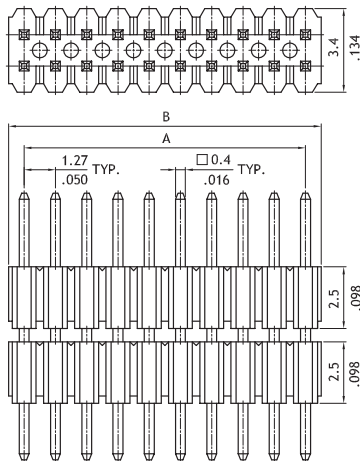
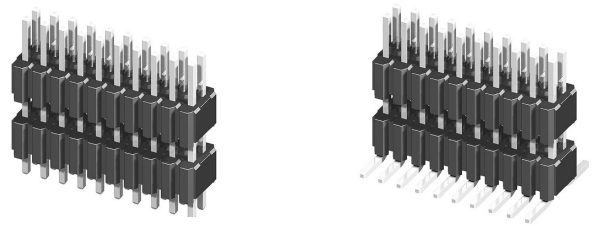

DIM. A = 1.27 X No. of Spaces  
 DIM. B = DIM. A + 1.27  
 DIM. E = 5.0 min.  
 Pin overall length 20.0mm max.

Option Code	Pin Dimension		
	C	D	E
00	3.0(.118)	2.3(.091)	5.0(.197)
01	3.0(.118)	2.3(.091)	6.0(.236)

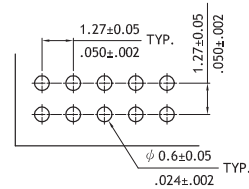

Recommended P.C. Board Layout

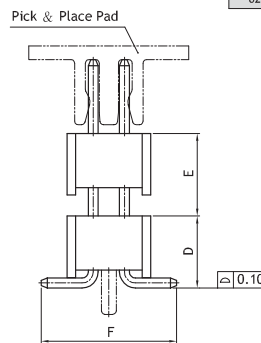
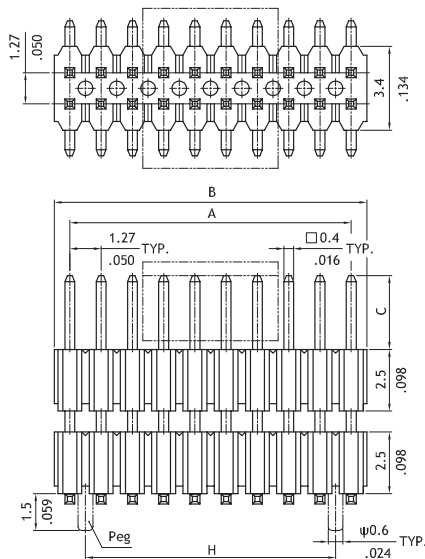

DIM. A = 1.27 X No. of Spaces  
 DIM. B = DIM. A + 1.27  
 DIM. H = DIM. A - 1.27  
 DIM. E = 2.5 min.  
 Pin overall length 20.0mm max.

Option Code	Pin Dimension			
	C	D	E	F
00	3.0(.118)	2.92(.115)	2.5(.098)	5.5(.217)
01	1.9(.074)	2.92(.115)	15.18(.597)	5.5(.217)
02	2.2(.087)	2.92(.115)	21.38(.842)	5.5(.217)

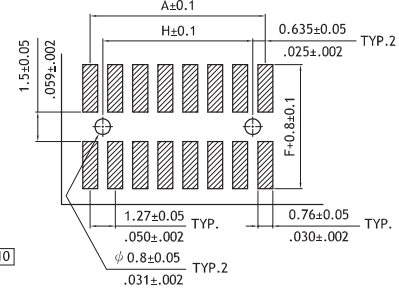

Recommended P.C. Board Layout

## Ordering Code

**1** CH **5** **7** **2** **V** **1** **00** - **0** **0**

- 1** Series No.
- 2** Circuits:  
06 to 100 (X1=100)
- 3** Plating code:  
2= Gold flash over Nickel  
\*Optional plating available but MOQ requested
- 4** Tail & Mounting Style:  
V= Vertical DIP Type  
M= Vertical SMT Type
- 5** Insulator Material & Color:  
1= Nylon 6T, Color Black
- 6** Other options: 00=Standard  
\* See option code table  
\* Consult manufacturer for customized pin length
- 7** 0= Without Peg  
P= With Pegs
- 8** 0= Without Pick & Place Pad (Tube or PVC Tray)  
P= With Pick & Place Pad (Tape & Reel)  
\*Code 7 and 8 for SMT type only