



SDC105R SERIES - SMD Power Inductors



PART NUMBERING SYSTEM

<u>SDC</u>	<u>1 0 5 R</u>	—	<u>1 5 0 N</u>
TYPE	DIMENSIONS		INDUCTANCE

SHAPES AND DIMENSIONS

UNIT : mm

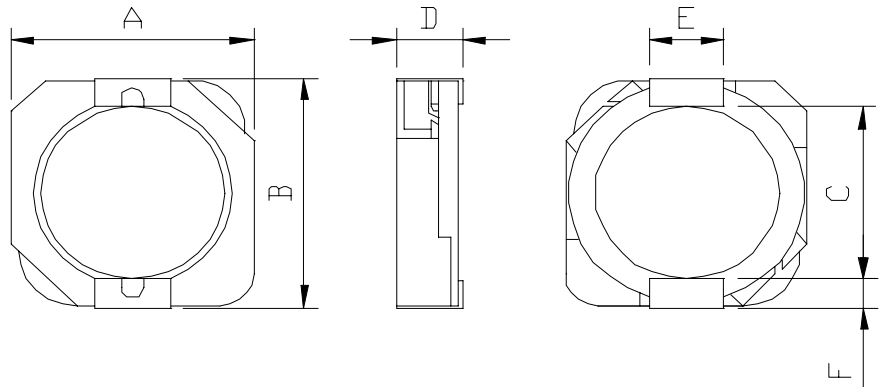

A=10.3 max. B=10.5 max. C=7.70 REF D=5.1 max. E=3.0 REF F=1.2 REF

RECOMMENDED PATTERNS

UNIT : mm

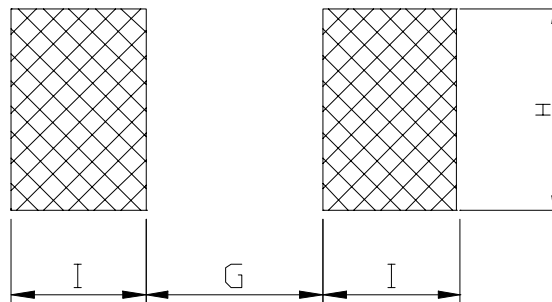

H= 3.2 G= 7.30 I = 1.60 J =1.60

FEATURES

- Compact and Low profile (5.1mm max. height) and 10.3mmx10.5mm max. square.
- Magnetically shielded and low DC resistance ..
- Choke coils for DC-DC converter inductor , LCD panels , DVD players Computer and portable power devices applications .



SDC105R SERIES

ELECTRICAL CHARACTERISTICS :

PART NUMBER	INDUCTANCE (μ H)	DCR (m Ω) (Max.)	IDC (A)	TEST FREQ. (f)
SDC105R-0R8N	0.8	4.3	7.50	100KHz
SDC105R-1R5N	1.5	5.8	5.00	100KHz
SDC105R-2R2N	2.2	7.2	6.30	100KHz
SDC105R-3R3N	3.3	10.4	5.75	100KHz
SDC105R-4R7N	4.7	12.3	4.75	100KHz
SDC105R-6R8N	6.8	18.0	4.10	100KHz
SDC105R-8R2N	8.2	20.0	4.00	100KHz
SDC105R-100N	10	26.0	3.75	100KHz
SDC105R-150N	15	41.0	2.65	100KHz
SDC105R-220N	22	61.0	1.80	100KHz
SDC105R-330N	33	84.0	1.65	100KHz
SDC105R-470N	47	130	1.50	100KHz
SDC105R-560N	56	149	1.45	100KHz
SDC105R-680N	68	201	1.20	100KHz
SDC105R-820N	82	227	0.95	100KHz
SDC105R-101N	100	253	0.90	100KHz
SDC105R-151N	150	370	0.80	100KHz
SDC105R-221N	220	500	0.70	100KHz
SDC105R-331N	330	812	0.50	100KHz

*.Operating temperature range : -40 $^{\circ}$ C to + 85 $^{\circ}$ C . Electrical specifications at 25 $^{\circ}$ C .

*.Infrared reflow temperature range : +260 $^{\circ}$ C . For 10 seconds .

*.The rated current indicate the current when the inductance decrease to 65% over of it's nominal value or D.C.current when the temperature rising Δ t=40 $^{\circ}$ C lower , whichever is lower .



SDC105R SERIES

PACKAGING SPECIFICATION

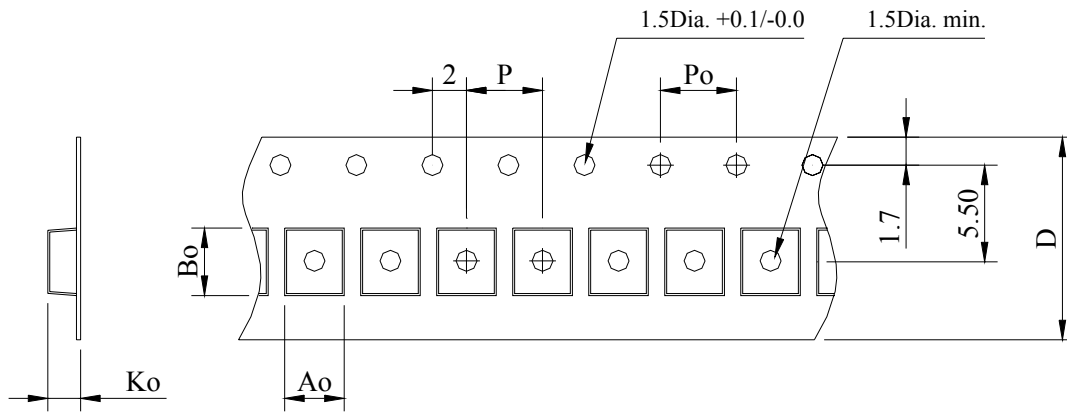

STAYLE	Q' TY (PCS)	DIMENSIONS (m/m)					
		Ao	Bo	Ko	P	Po	D±0.3
13"	1,000	10.4	10.4	5.1	16.0	4.00	24.0