

SPECIFICATION:

- 1. RATING : 15A 250VAC (UL,CSA)
10A 250V- (VDE)
- 2. INSULATION RESISTANCE : DC 500V 100M Ω OR MORE
- 3. WITHSTAND VOLTAGE : 2000V RMS 50/60Hz 1 Min.

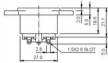

TERMINAL'S TYPE	
1	SOLDER TERMINAL
2	SOLDER TERMINAL
3	QUICK TERMINAL
4	QUICK TERMINAL
5	PC TERMINAL (90°)

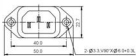

SPECIFICATION:

- 1. RATING : 15A 125VAC
- 2. INSULATION RESISTANCE : DC 500V 100M Ω OR MORE
- 3. WITHSTAND VOLTAGE : AC 1500V 1 Min. OR MORE
- 4. CONTACT RESISTANCE : DC 2-4V 1A 50m Ω OR LESS

