

SMT Circuit Protector

Surface Mount Over Current Protection

3216CP



Catalog Symbol: 3216CP
 Voltage Rating: 24 VDC
 Interrupting Rating: 35 Amp DC, Battery Source
 Interruption Time:
 10 Sec. Max. @ 250% Rated Current
 1 mSec. Typ. @ 600% Rated Current
 Physical Size:
 EIA SOCM-3216 AC (equivalent to 1206)
 3.2 × 1.6 × 0.90mm
 0.126 × 0.0634 × 0.035 in.
 Agency Approvals:
 UL Recognition, Std. 248-14, File E19180, Guide JDYX2
 CSA Component Acceptance, File 53787, Class 1422-30
 General Information:

- Rapid interruption of excessive current
- Compatible with reflow and wave solder
- Rugged ceramic and glass construction
- Excellent environmental integrity
- One time positive disconnect

Dimensions - mm (inches)

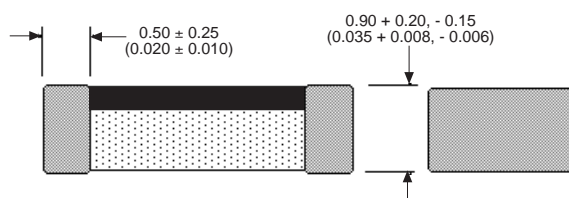
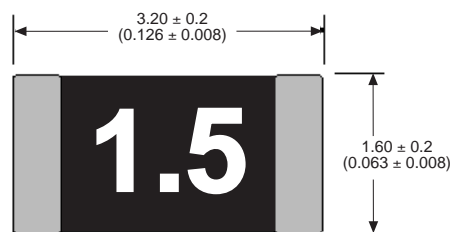

Packaging and Ordering Information:

Tape and Reel: Standard 8mm tape, in compliance with EIA-RS481 (equivalent to IEC 286, Part 3).

	3216CP	(See Table)
	Product Symbol	Rated Current

Package Code
TR = 3,000 pieces on tape on a 178mm reel.
TR1 = 15,000 pieces on tape on a 330mm reel.
SP = 50 pieces on tape in a plastic box.
 Contact Bussmann if other package quantities are required.

Electrical Characteristics

Part Number (XX= Package Code)	Current Rating (Amperes)	Typ. Resistance @ ≤ 10% Rated Current (Ohms)	Typical Voltage Drop @ Rated Current (Volts)
XX/3216CP-250mA	.250	4.50	1.4
XX/3216CP-375mA	.375	1.80	.73
XX/3216CP-500mA	.500	1.15	.66
XX/3216CP-750mA	.750	.75	.63
XX/3216CP-1A	1	.168	.20
XX/3216CP-1.5A	1.5	.098	.18
XX/3216CP-2A	2	.063	.16
XX/3216CP-2.5A	2.5	.046	.14
XX/3216CP-3A	3	.037	.13
XX/3216CP-4A	4	.019	.11
XX/3216CP-4.5A	4.5	.014	.10
XX/3216CP-5A	5	.013	.09

- General Notes:
1. Device designed to carry rated current for four hours minimum. An operating current of 80% or less of rated current is recommended, with further derating required at elevated ambient temperatures.
 2. All measurements made at 23 ± 3°C ambient temperature with the device mounted on a suitable circuit board trace.
 3. It is recommended that circuit protectors be mounted with glass side facing up.
 4. It is recommended that fuses be mounted with ceramic (white) side facing up.
 5. Contact Bussmann if higher ampere ratings are needed.

SMT Circuit Protector

Surface Mount Over Current Protection

3216CP

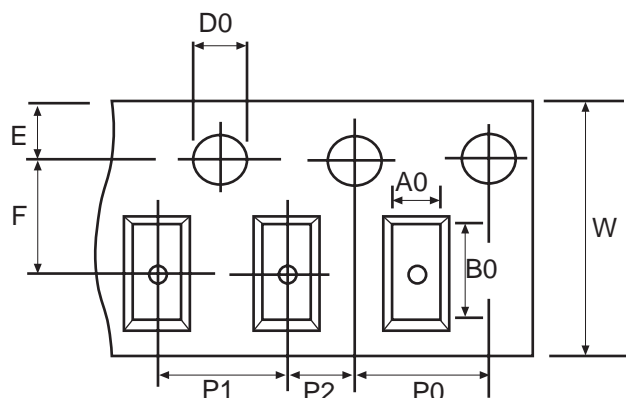

Recommended Land Pattern - mm (inches)

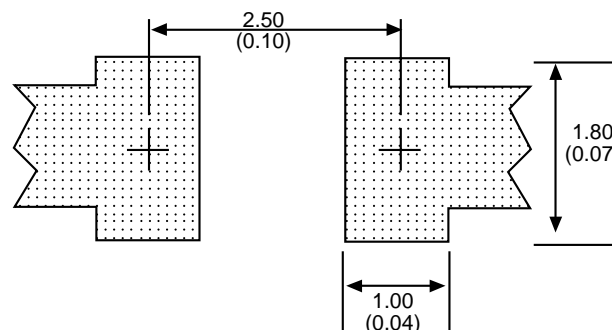

Tape dimensions - mm	
W	8.0 + 0.3/0.1
F	3.5 ± 0.05
E	1.75 ± 0.1
P2	2.0 ± 0.05
P0	4.0 ± 0.1
P1	4.0 ± 0.1
AO	1.73 ± 0.2
BO	3.56 ± 0.2
DO	1.5 + 0.1/ -0.0

Environmental Specifications

Operating Temperature Range:

-55 to +125° C, with proper derating.

Thermal Shock:

MIL-STD-202, Method 107, Test Condition B (-65 to 125° C).

Vibration:

MIL-STD-202, Method 204, Test Condition C (55 to 2000Hz, 10 G).

Solderability:

Withstands 60 seconds above 200° C, 260° C maximum.

Moisture Resistance:

MIL-STD-202, Method 106, 10 day cycle.

The only controlled copy of this BIF document is the electronic read-only version located on the Bussmann Network Drive. All other copies of this BIF document are by definition uncontrolled. This bulletin is intended to clearly present comprehensive product data and provide technical information that will help the end user with design applications. Bussmann reserves the right, without notice, to change design or construction of any products and to discontinue or limit distribution of any products. Bussmann also reserves the right to change or update, without notice, any technical information contained in this bulletin. Once a product has been selected, it should be tested by the user in all possible applications.