

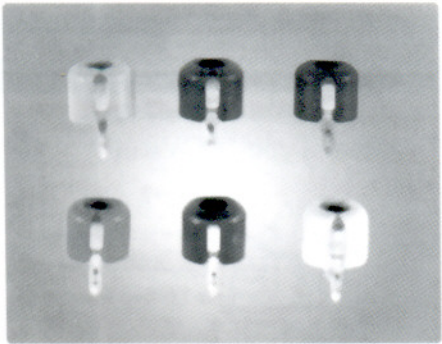

CVN6 SERIES



- FEATURES :**
- Flame retardant plastic case.
 - Excellent shock resistance.
 - Most suitable for insertion machine, easy to adjust.
 - Flow solderable for rear adjusting type.
 - Sealed construction prevents the penetration of flux and dust.

The CVN6 Series is tough constructed ceramic trimmer capacitor without a center axis, and are of unique double encased types against shock in automatic assembly. The rotor in the case is arranged to turn quite smoothly, featuring wide range of nominal capacitance.

HOW TO ORDER

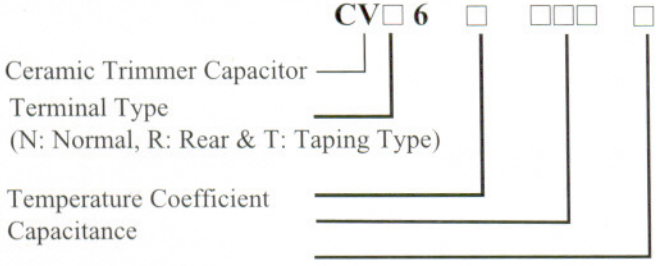

Sealing (A: Not Provided, B: Provided)
 *Packing: 200 pcs/bag

Specifications

- Operating Temperature Range: -25°C ~ +85°C
- Rated Working Voltage: 100V DC
- Dielectric Withstanding Voltage: 220V DC
- Insulation Resistance: 10⁴M ohm min.
- Rotation Torque: 20~200g.cm

RATINGS

Part Number	Capacitance (pF)		Temperature Coefficient (ppm/°C)	Q (1MHz, Cmax.) (min.)	Case Color
	Min. (+0%)	Max.			
CV□6A 003 □	1.5	3.0 (+50%/-0%)	NP 0 +/- 200	500	Black
CV□6A 005 □	2.0	5.0 (+50%/-0%)	NP 0 +/- 200	500	Blue
CV□6A 007 □	2.0	7.0 (+50%/-0%)	NP 0 +/- 200	500	Blue
CV□6B 010 □	2.1	10.0 (+50%/-0%)	N 200 +/- 200	500	Blue
CV□6C 010 □	3.0	10.0 (+50%/-0%)	N 450 +/- 300	500	White
CV□6A 011 □	3.0	11.0 (+50%/-0%)	NP 0 +/- 200	500	Blue
CV□6C 011 □	3.0	11.0 (+50%/-0%)	N 450 +/- 300	500	White
CV□6C 020 □	4.2	20.0 (+50%/-0%)	N 450 +/- 300	500	Red
CV□6D 020 □	4.2	20.0 (+50%/-0%)	N 750 +/- 300	500	Red
CV□6D T30 □	5.2	30.0 (+50%/-0%)	N 750 +/- 300	500	Green
CV□6D 030 □	6.2	30.0 (+50%/-0%)	N 750 +/- 300	500	Green
CV□6E 040 □	6.8	40.0 (+50%/-0%)	N 1200 +/- 500	500	Yellow
CV□6E 050 □	9.8	50.0 (+50%/-0%)	N 1200 +/- 500	300	Brown
CV□6E 060 □	10.2	60.0 (+50%/-0%)	N 1200 +/- 500	200	Brown
CV□6E 070 □	13.0	70.0 (+50%/-0%)	N 1200 +/- 500	200	Brown
CV□6E 090 □	20.0	90.0 (+50%/-0%)	N 1200 +/- 500	150	Brown
CV□6E 120 □	25.0	120.0 (+50%/-0%)	N 1200 +/- 500	150	Black



CVN6 SERIES

DIMENSIONS (Unit: mm Tolerance: ± 0.5)

Normal Type (CVN6□□□□□)

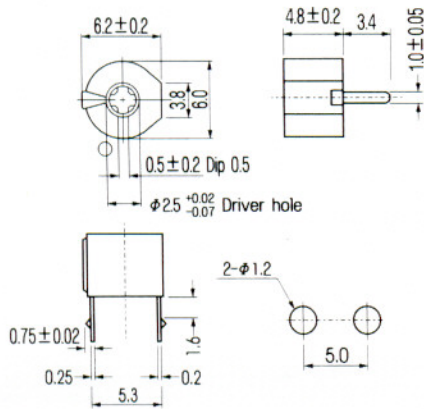

Rear Type (CVR6□□□□□)

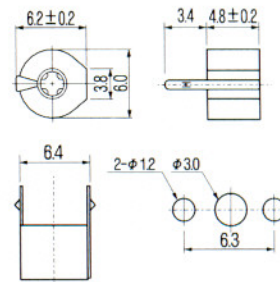

Seal Type (CV□6□□□□□B)

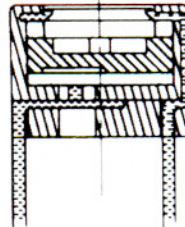

Tapping Type (CVT6□□□□□)

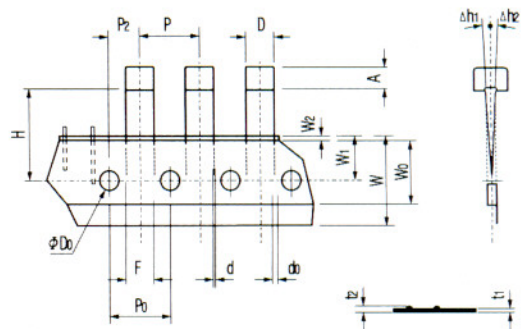
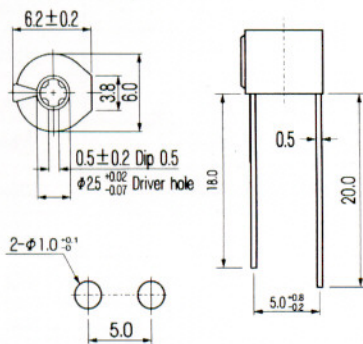

Features

- 2 minutes immersion in solvent or 30 seconds ultrasonic cleaning can be performed.
- Flux troubles have been eliminated
- Flow soldering can be performed for rear adjustment.
- Closed construction with seal ring eliminates film breakage and other problems like ceramic breakage.

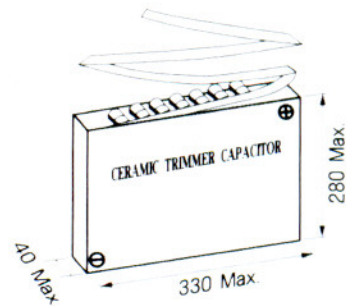

Packing Unit: 2000 pcs



ELECTRICAL CHARACTERISTICS

Q vs Frequency

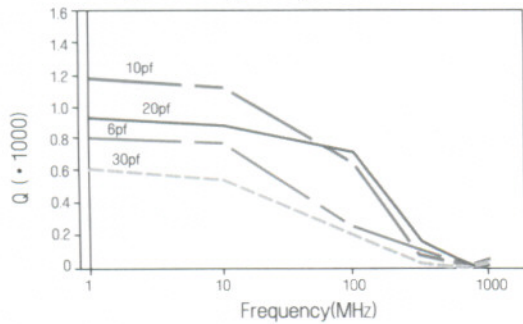

Temperature Characteristics

CVN6A005A

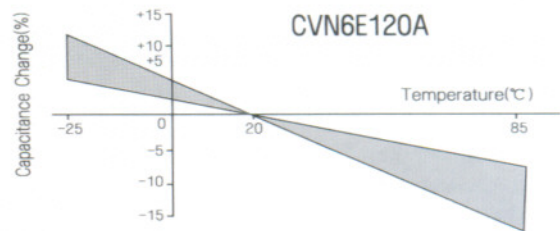
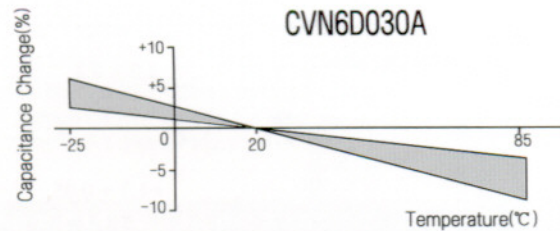
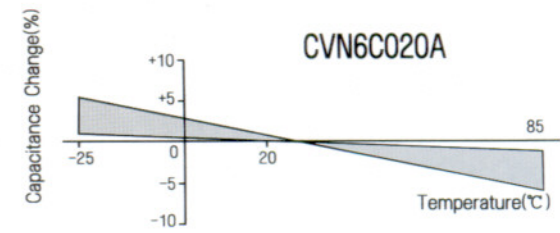
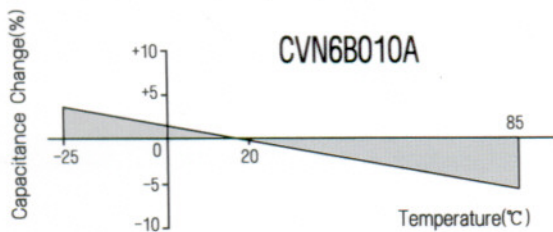
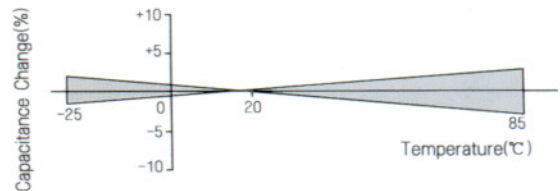

Soldering Conditions

Soldering temperature and time
Solder within the range indicated by the slanted line. If soldering is repeated, please note that the allowed time is the accumulated time.

Flow Solder

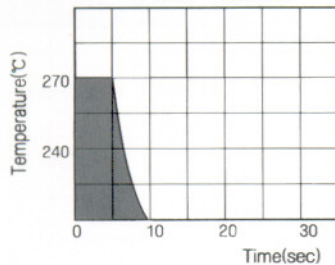

Flow solder

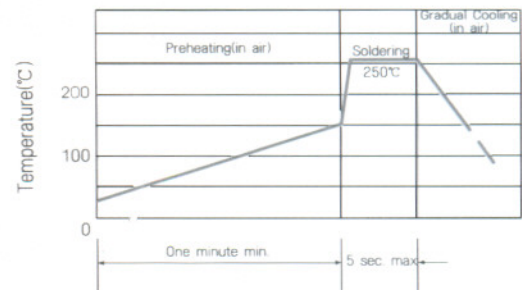

Standard Soldering Conditions

Cleaning Conditions (Sealing Type)

Cleaning with solvent must be done for less than 2 minutes, but supersonic cleaning should be completed within 1 minute. In the case of only immersion washing with room temperature can be done for 5 minutes.



TRIMMING CAPACITOR

CROSS REFERENCE

CVS3 Series	BARONS		MURATA	KYOCERA	MATSUSHITA (Panasonic)
	Part No.	Cap. Value	PART NO.	PART NO.	PART NO.
	CVS303	1.7/3.0	TZC03Z030A	CTZ3□-03A	ECRKN003A
	CVS306	2.5/6.0	TZC03Z060A	CTZ3□-05A	ECRKN006A
	CVS306	2.5/6.0	TZC03Z060A	CTZ3□-05C	ECRKN006A
	CVS310	3.5/10.0	TZC03R100A	CTZ3□-10C	ECRKN010C
	CVS320	5.5/20.0	TZC03P200A	CTZ3□-20C	ECRKN020E
	CVS330	7.5/30.0	TZC03P300A	CTZ3□-30C	ECRKN030G

CVO5 Series	BARONS		MURATA	KYOCERA	MATSUSHITA (Panasonic)
	Part No.	Cap. Value	PART NO.	PART NO.	PART NO.
	CVO5A030	1.0/3.0			ECV1ZW02X
	CVO5A050	2.0/5.0			ECV1ZW04X
	CVO5B100	3.0/10.0			ECV1ZW08X
	CVO5C200	4.8/20.0			
	CVO5E300	5.5/30.0			ECV1ZW30X
	CVO5G400	6.8/40.0			ECV1ZW40X
	CVO5G500	9.0/50.0			
	CVO5H600	12.0/60.0			
	CVO5H700	14.0/70.0			
	CVO5H900	16.0/90.0			ECV1ZW90X

CVN6 Series	BARONS		MURATA	KYOCERA	MATSUSHITA (Panasonic)
	Part No.	Cap. Value	PART NO.	PART NO.	PART NO.
	CV□6A005	2.0/5.0			
	CV□6A007	2.0/7.0	TZ03Z070		
	CV□6B010	2.1/10.0	TZ03N100		
	CV□6C010	3.0/10.0	TZ03Z100		
	CV□6A011	3.0/11.0			
	CV□6C011	3.0/11.0	TZ03T110		
	CV□6C020	4.2/20.0	TZ03T200		
	CV□6D020	4.2/20.0	TZ03R200		
	CV□6DT30	5.2/30.0	TZ03R300		
	CV□6D030	6.2/30.0			
	CV□6E040	6.8/40.0	TZ03P450		
	CV□6E050	9.8/50.0			
	CV□6E060	10.2/60.0	TZ03P600		
	CV□6E070	13.0/70.0			
	CV□6E090	20.0/90.0			
	CV□6E120	25.0/120.0			