



2001'

***PRODUCTS
CATALOGUE***



SUN RISE COMPONENT LIMITED

* BUILD YOUR OWN DC POWER JACKS ORDER FORMAT *

Fill in all boxes shown with options selected from below.

SERIES		SEQUENTIAL NO.	EXTEND VERSION	FEATURE	PART OF PIN DIAMETER	TREATMENT	COLOR OPTION
D	C	04	2	0	01	0	6

SERIES:

DC = DC Power Jacks

SEQUENTIAL NO.:

01-99 = Version Specification

EXTEND VERSION:

0 = Standard or Nil

1-9 = Individual Extend

FEATURE:

0 = Standard or Nil

B = Bend Lead Terminal (Snap-in)

H = Heat Resistance Version

L = SMD Surface Mount Version

N = Without Sleeve Break Terminal

S = Short Pin Version

X = Customer Version

TREATMENT:

0 = Standard Plated

U = Pin in (Au) Gold Plated

V = Terminal in (Au) Gold Plated

W = Pin & Terminal in (Au) Gold Plated

COLOR OPTION:

0 = Black

1 = White

2 = Red

3 = Green

4 = Yellow

5 = Blue

6 = Grey

7 = Orange

8 = Purple

9 = Pink

PART OF PIN DIAMETER:

01-99 = Individual Specification

REMARKS: For SMD Surface Mount Version, the Reel Carrier Tape Packing is available.
(please consult with **Sun Rise**)

DC POWER JACKS

DC-010-0

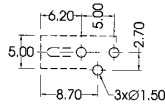

PIERCING PLAN



SCHEMATIC

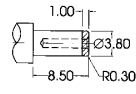
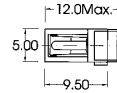

MATE PLUG

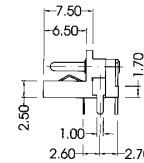
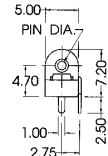

PART NO.	PIN DIA.
DC-010-001	Ø1.00mm
DC-010-002	Ø1.30mm

DC-011-0

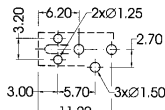

PIERCING PLAN



SCHEMATIC

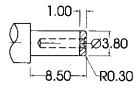
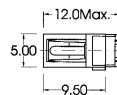

MATE PLUG

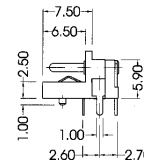
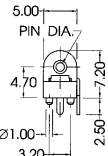

PART NO.	PIN DIA.
DC-011-001	Ø1.00mm
DC-011-002	Ø1.30mm

DC-020-0

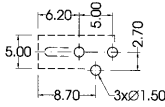

PIERCING PLAN



SCHEMATIC

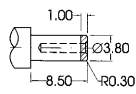
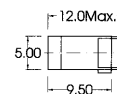

MATE PLUG

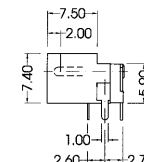
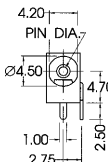

PART NO.	PIN DIA.
DC-020-001	Ø1.00mm
DC-020-002	Ø1.30mm

DC-021-0

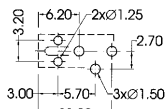

PIERCING PLAN



SCHEMATIC

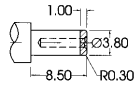
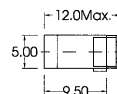

MATE PLUG

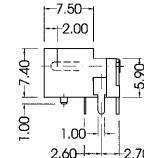
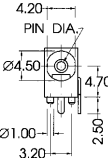

PART NO.	PIN DIA.
DC-021-001	Ø1.00mm
DC-021-002	Ø1.30mm

DC-030-0

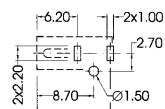

PIERCING PLAN



SCHEMATIC

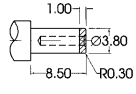
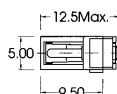

MATE PLUG

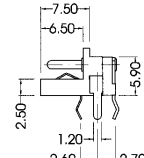
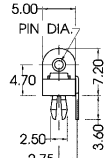

PART NO.	PIN DIA.
DC-030-001	Ø1.00mm
DC-030-002	Ø1.30mm

DC POWER JACKS

DC-031-0

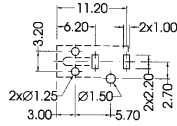

PIERCING PLAN

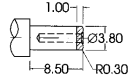

MATE PLUG



SCHEMATIC

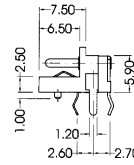
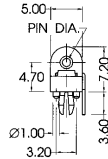
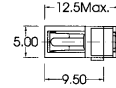

PART NO.	PIN DIA.
DC-031-001	Ø1.00mm
DC-031-002	Ø1.30mm

DC-040-0

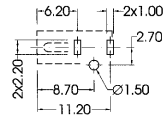

PIERCING PLAN

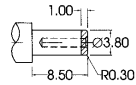

MATE PLUG



SCHEMATIC

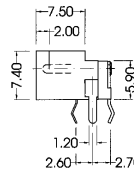
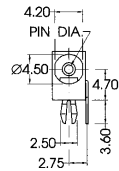
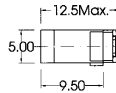

PART NO.	PIN DIA.
DC-040-001	Ø1.00mm
DC-040-002	Ø1.30mm

DC-041-0

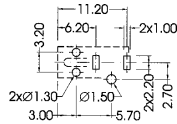

PIERCING PLAN

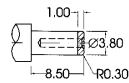

MATE PLUG



SCHEMATIC

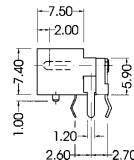
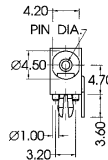
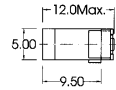

PART NO.	PIN DIA.
DC-041-001	Ø1.00mm
DC-041-002	Ø1.30mm

DC-042-0

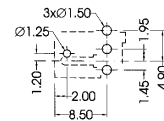

PIERCING PLAN

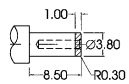

MATE PLUG



SCHEMATIC

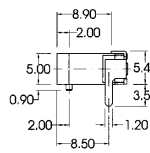
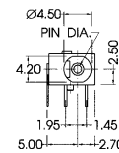
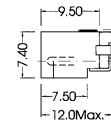

PART NO.	PIN DIA.
DC-042-001	Ø1.00mm
DC-042-002	Ø1.30mm

DC-050-0

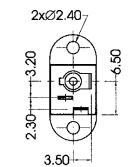

BOTTOM VIEW

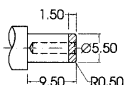

MATE PLUG



SCHEMATIC

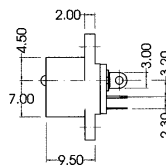
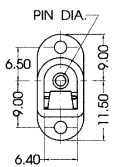
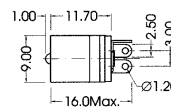

PART NO.	PIN DIA.
DC-050-001	Ø1.45mm
DC-050-002	Ø1.87mm
DC-050-003	Ø2.00mm
DC-050-004	Ø2.35mm
DC-050-005	Ø2.50mm

DC POWER JACKS

DC-051-0

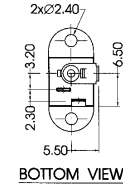

BOTTOM VIEW

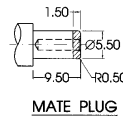

MATE PLUG

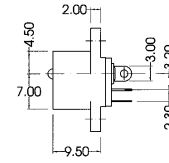
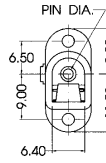
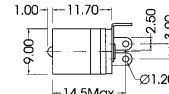

PART NO.	PIN DIA.
DC-051-001	\varnothing 1.45mm
DC-051-002	\varnothing 1.87mm
DC-051-003	\varnothing 2.00mm
DC-051-004	\varnothing 2.35mm
DC-051-005	\varnothing 2.50mm

DC-060-0

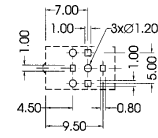

PIERCING PLAN

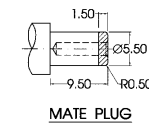

MATE PLUG

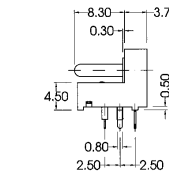
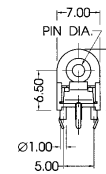
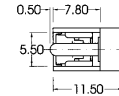

PART NO.	PIN DIA.
DC-060-001	\varnothing 1.45mm
DC-060-002	\varnothing 1.87mm
DC-060-003	\varnothing 2.00mm
DC-060-004	\varnothing 2.35mm
DC-060-005	\varnothing 2.50mm

DC-070-0

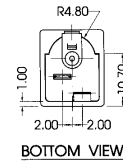

BOTTOM VIEW

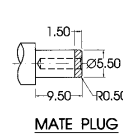

MATE PLUG

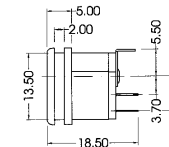
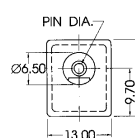
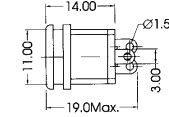
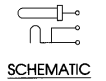

PART NO.	PIN DIA.
DC-070-001	\varnothing 1.45mm
DC-070-002	\varnothing 1.87mm
DC-070-003	\varnothing 2.00mm
DC-070-004	\varnothing 2.35mm
DC-070-005	\varnothing 2.50mm

DC-080-0

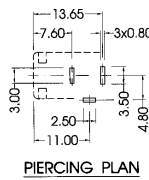

PIERCING PLAN

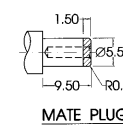

MATE PLUG

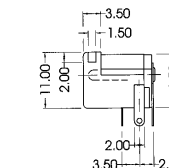
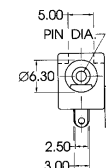
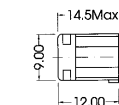

PART NO.	PIN DIA.
DC-080-001	\varnothing 1.45mm
DC-080-002	\varnothing 1.87mm
DC-080-003	\varnothing 2.00mm
DC-080-004	\varnothing 2.35mm
DC-080-005	\varnothing 2.50mm

DC-090-0

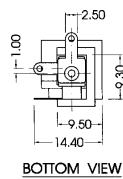

BOTTOM VIEW

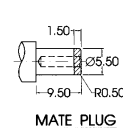

MATE PLUG

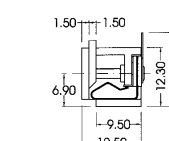
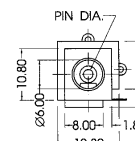
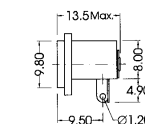

PART NO.	PIN DIA.
DC-090-001	\varnothing 1.45mm
DC-090-002	\varnothing 1.87mm
DC-090-003	\varnothing 2.00mm
DC-090-004	\varnothing 2.35mm
DC-090-005	\varnothing 2.50mm

DC POWER JACKS

DC-091-0

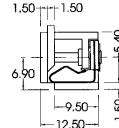
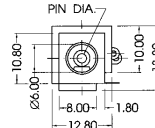
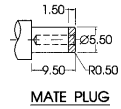
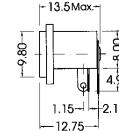
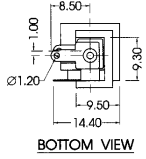

PART NO.	PIN DIA.
DC-091-001	Ø1.45mm
DC-091-002	Ø1.87mm
DC-091-003	Ø2.00mm
DC-091-004	Ø2.35mm
DC-091-005	Ø2.50mm

DC-100-0

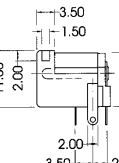
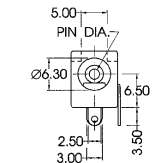
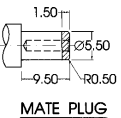
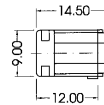
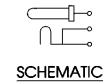
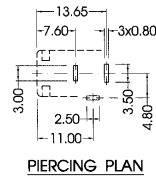

PART NO.	PIN DIA.
DC-100-001	Ø1.45mm
DC-100-002	Ø1.87mm
DC-100-003	Ø2.00mm
DC-100-004	Ø2.35mm
DC-100-005	Ø2.50mm

DC-100-B

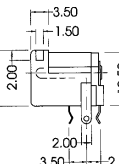
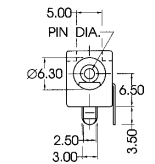
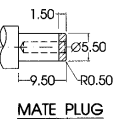
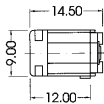
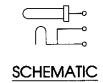
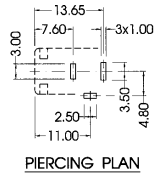

PART NO.	PIN DIA.
DC-100-B01	Ø1.45mm
DC-100-B02	Ø1.87mm
DC-100-B03	Ø2.00mm
DC-100-B04	Ø2.35mm
DC-100-B05	Ø2.50mm

DC-110-0

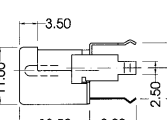
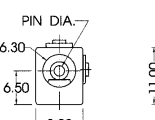
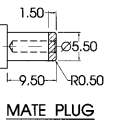
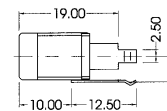
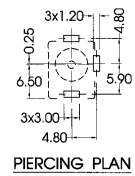

PART NO.	PIN DIA.
DC-110-001	Ø1.45mm
DC-110-002	Ø1.87mm
DC-110-003	Ø2.00mm
DC-110-004	Ø2.35mm
DC-110-005	Ø2.50mm

DC-111-0

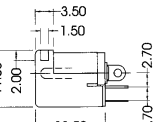
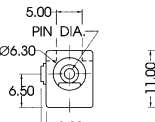
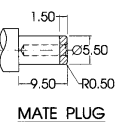
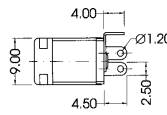
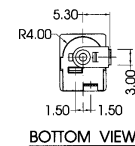

PART NO.	PIN DIA.
DC-111-001	Ø1.45mm
DC-111-002	Ø1.87mm
DC-111-003	Ø2.00mm
DC-111-004	Ø2.35mm
DC-111-005	Ø2.50mm

DC POWER JACKS

DC-112-0

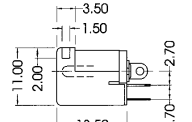
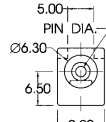
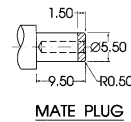
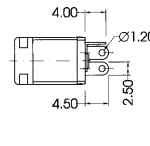
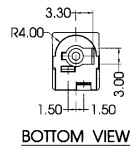

PART NO.	PIN DIA.
DC-112-001	Ø1.45mm
DC-112-002	Ø1.87mm
DC-112-003	Ø2.00mm
DC-112-004	Ø2.35mm
DC-112-005	Ø2.50mm

DC-113-0

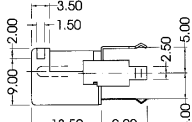
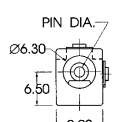
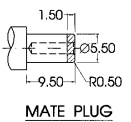
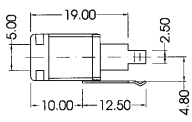
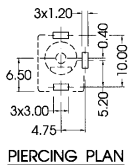

PART NO.	PIN DIA.
DC-113-001	Ø1.45mm
DC-113-002	Ø1.87mm
DC-113-003	Ø2.00mm
DC-113-004	Ø2.35mm
DC-113-005	Ø2.50mm

DC-114-0

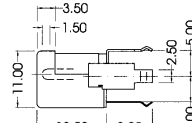
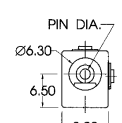
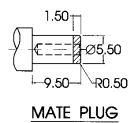
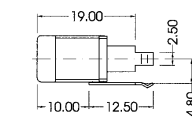
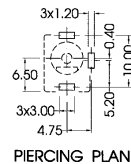

PART NO.	PIN DIA.
DC-114-001	Ø1.45mm
DC-114-002	Ø1.87mm
DC-114-003	Ø2.00mm
DC-114-004	Ø2.35mm
DC-114-005	Ø2.50mm

DC-120-0

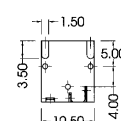
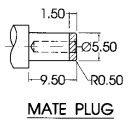
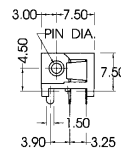
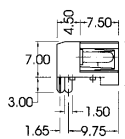
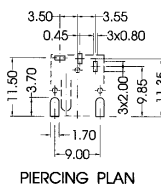

PART NO.	PIN DIA.
DC-120-001	Ø1.45mm
DC-120-002	Ø1.87mm
DC-120-003	Ø2.00mm
DC-120-004	Ø2.35mm
DC-120-005	Ø2.50mm

DC-121-0

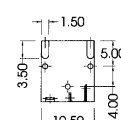
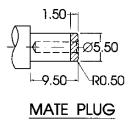
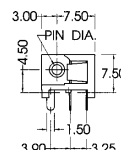
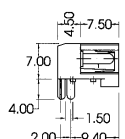
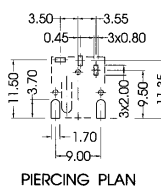

PART NO.	PIN DIA.
DC-121-001	Ø1.45mm
DC-121-002	Ø1.87mm
DC-121-003	Ø2.00mm
DC-121-004	Ø2.35mm
DC-121-005	Ø2.50mm

DC POWER JACKS

DC-130-0

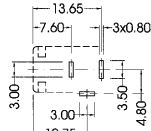

PIERCING PLAN

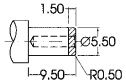

MATE PLUG



SCHEMATIC

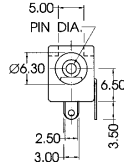

PIN DIA.

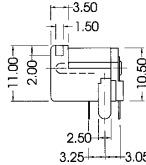
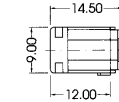

PART NO.	PIN DIA.
DC-130-001	Ø1.45mm
DC-130-002	Ø1.87mm
DC-130-003	Ø2.00mm
DC-130-004	Ø2.35mm
DC-130-005	Ø2.50mm

DC-130-B

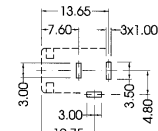

PIERCING PLAN

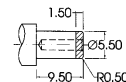

MATE PLUG



SCHEMATIC

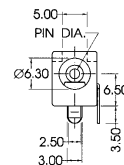

PIN DIA.

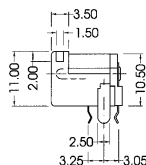
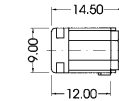

PART NO.	PIN DIA.
DC-130-B01	Ø1.45mm
DC-130-B02	Ø1.87mm
DC-130-B03	Ø2.00mm
DC-130-B04	Ø2.35mm
DC-130-B05	Ø2.50mm

DC-140-0

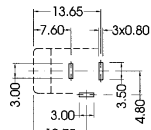

PIERCING PLAN

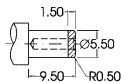

MATE PLUG



SCHEMATIC

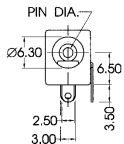

PIN DIA.

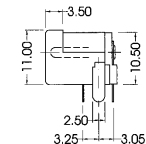
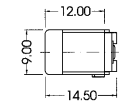

PART NO.	PIN DIA.
DC-140-001	Ø1.45mm
DC-140-002	Ø1.87mm
DC-140-003	Ø2.00mm
DC-140-004	Ø2.35mm
DC-140-005	Ø2.50mm

DC-140-B

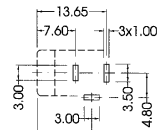

PIERCING PLAN

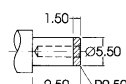

MATE PLUG



SCHEMATIC

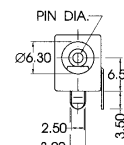

PIN DIA.

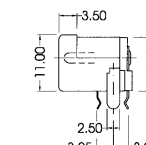
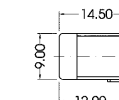

PART NO.	PIN DIA.
DC-140-B01	Ø1.45mm
DC-140-B02	Ø1.87mm
DC-140-B03	Ø2.00mm
DC-140-B04	Ø2.35mm
DC-140-B05	Ø2.50mm

DC-150-0

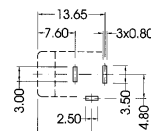

PIERCING PLAN

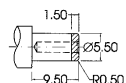

MATE PLUG



SCHEMATIC

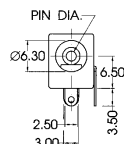

PIN DIA.

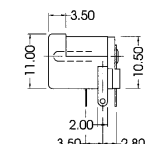
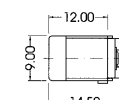

PART NO.	PIN DIA.
DC-150-001	Ø1.45mm
DC-150-002	Ø1.87mm
DC-150-003	Ø2.00mm
DC-150-004	Ø2.35mm
DC-150-005	Ø2.50mm

DC POWER JACKS

DC-150-B

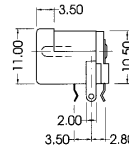
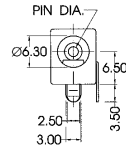
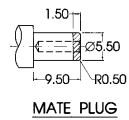
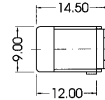
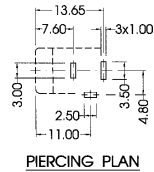

PART NO.	PIN DIA.
DC-150-B01	Ø1.45mm
DC-150-B02	Ø1.87mm
DC-150-B03	Ø2.00mm
DC-150-B04	Ø2.35mm
DC-150-B05	Ø2.50mm

DC-160-0

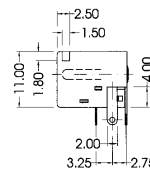
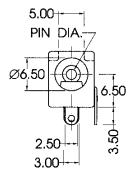
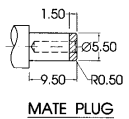
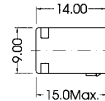
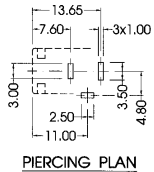

PART NO.	PIN DIA.
DC-160-001	Ø1.45mm
DC-160-002	Ø1.87mm
DC-160-003	Ø2.00mm
DC-160-004	Ø2.35mm
DC-160-005	Ø2.50mm

DC-160-B

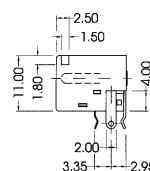
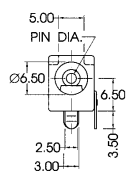
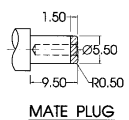
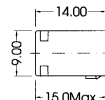
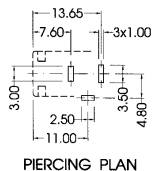

PART NO.	PIN DIA.
DC-160-B01	Ø1.45mm
DC-160-B02	Ø1.87mm
DC-160-B03	Ø2.00mm
DC-160-B04	Ø2.35mm
DC-160-B05	Ø2.50mm

DC-170-0

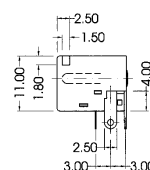
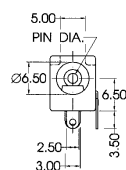
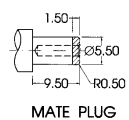
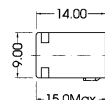
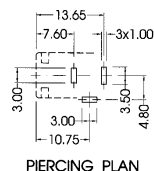

PART NO.	PIN DIA.
DC-170-001	Ø1.45mm
DC-170-002	Ø1.87mm
DC-170-003	Ø2.00mm
DC-170-004	Ø2.35mm
DC-170-005	Ø2.50mm

DC-170-B

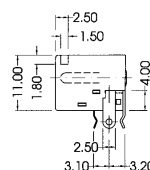
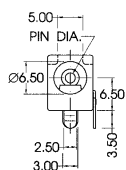
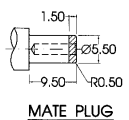
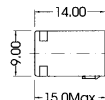
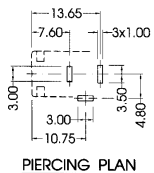

PART NO.	PIN DIA.
DC-170-B01	Ø1.45mm
DC-170-B02	Ø1.87mm
DC-170-B03	Ø2.00mm
DC-170-B04	Ø2.35mm
DC-170-B05	Ø2.50mm

DC POWER JACKS

DC-180-0

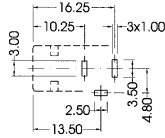

PIERCING PLAN

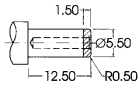

MATE PLUG



SCHEMATIC

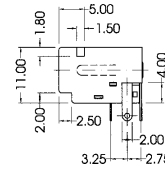
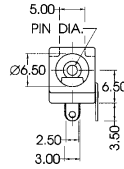
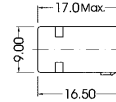

PART NO.	PIN DIA.
DC-180-001	Ø1.45mm
DC-180-002	Ø1.87mm
DC-180-003	Ø2.00mm
DC-180-004	Ø2.35mm
DC-180-005	Ø2.50mm

DC-180-B

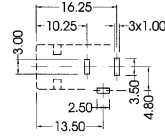

PIERCING PLAN

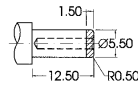

MATE PLUG



SCHEMATIC

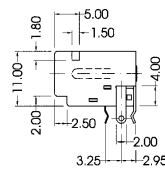
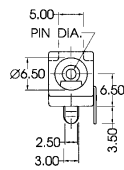
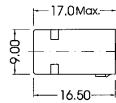

PART NO.	PIN DIA.
DC-180-B01	Ø1.45mm
DC-180-B02	Ø1.87mm
DC-180-B03	Ø2.00mm
DC-180-B04	Ø2.35mm
DC-180-B05	Ø2.50mm

DC-190-0

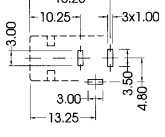

PIERCING PLAN

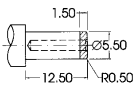

MATE PLUG



SCHEMATIC

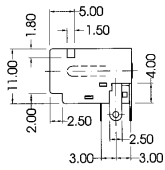
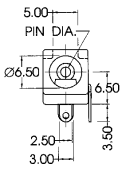
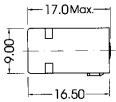

PART NO.	PIN DIA.
DC-190-001	Ø1.45mm
DC-190-002	Ø1.87mm
DC-190-003	Ø2.00mm
DC-190-004	Ø2.35mm
DC-190-005	Ø2.50mm

DC-190-B

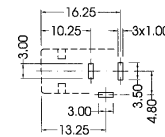

PIERCING PLAN

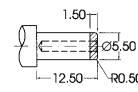

MATE PLUG



SCHEMATIC

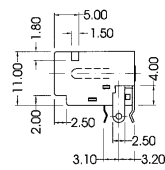
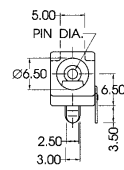
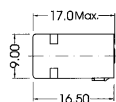

PART NO.	PIN DIA.
DC-190-B01	Ø1.45mm
DC-190-B02	Ø1.87mm
DC-190-B03	Ø2.00mm
DC-190-B04	Ø2.35mm
DC-190-B05	Ø2.50mm

DC-200-0

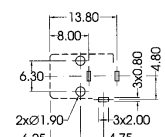

PIERCING PLAN

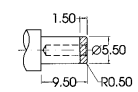

MATE PLUG



SCHEMATIC

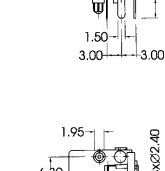
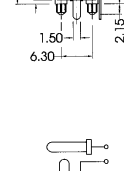
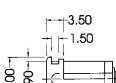

PART NO.	PIN DIA.
DC-200-001	Ø1.45mm
DC-200-002	Ø1.87mm
DC-200-003	Ø2.00mm
DC-200-004	Ø2.35mm
DC-200-005	Ø2.50mm

DC POWER JACKS

DC-210-001

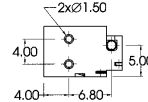
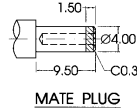
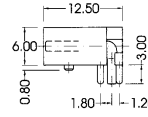
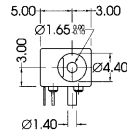
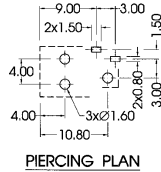

PART NO.	PIN DIA.
DC-210-001	Ø1.65mm

DC-210-B01

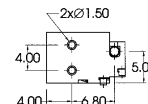
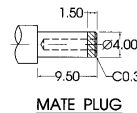
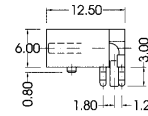
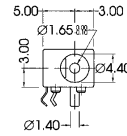
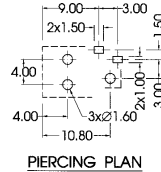

PART NO.	PIN DIA.
DC-210-B01	Ø1.65mm

DC-220-001

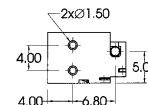
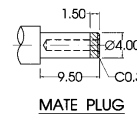
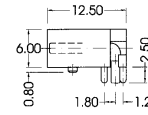
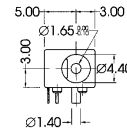
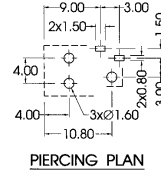

PART NO.	PIN DIA.
DC-220-001	Ø1.65mm

DC-220-B01

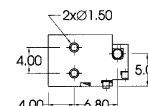
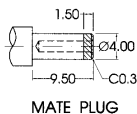
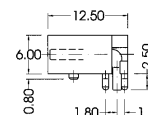
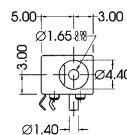
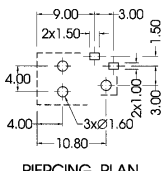

PART NO.	PIN DIA.
DC-220-B01	Ø1.65mm

DC-230-0

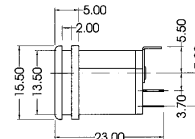
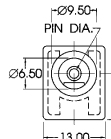
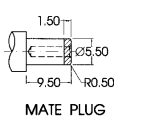
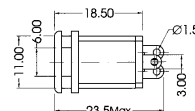
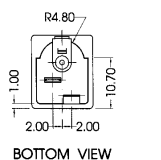

PART NO.	PIN DIA.
DC-230-001	Ø1.45mm
DC-230-002	Ø1.87mm
DC-230-003	Ø2.00mm
DC-230-004	Ø2.35mm
DC-230-005	Ø2.50mm

DC POWER JACKS

AVAILABLE
2001'

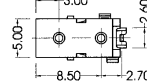
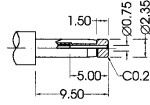
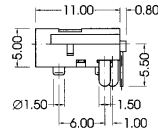
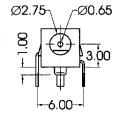
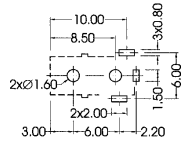

PART NO.	PIN DIA.
DC-240-001	Ø0.65mm

AVAILABLE
2001'

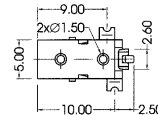
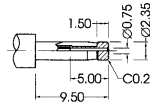
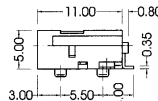
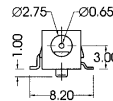
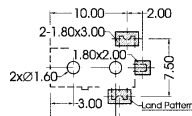

PART NO.	PIN DIA.
DC-240-L01	Ø0.65mm

AVAILABLE
2001'

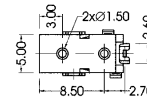
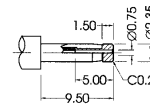
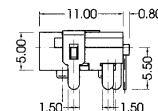
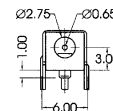
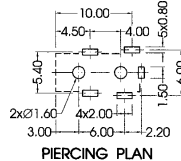

PART NO.	PIN DIA.
DC-241-001	Ø0.65mm

AVAILABLE
2001'

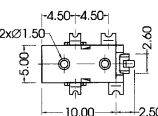
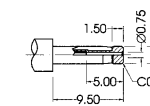
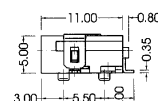
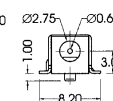
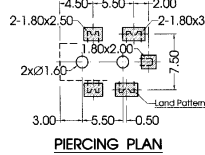

PART NO.	PIN DIA.
DC-241-L01	Ø0.65mm

DC-250-001

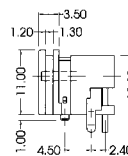
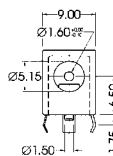
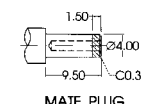
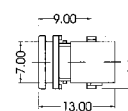
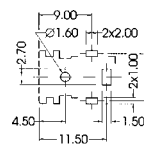

PART NO.	PIN DIA.
DC-250-001	Ø1.65mm

DC POWER JACKS

DC-260-0

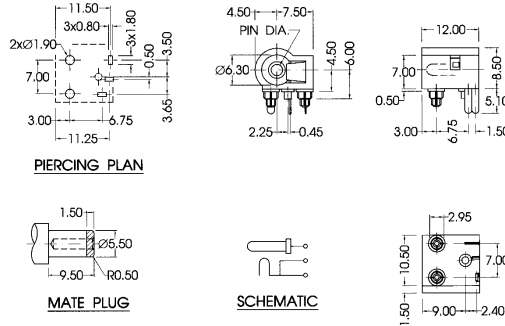

PART NO.	PIN DIA.
DC-260-001	Ø1.45mm
DC-260-002	Ø1.87mm
DC-260-003	Ø2.00mm
DC-260-004	Ø2.35mm
DC-260-005	Ø2.50mm

DC-270-001

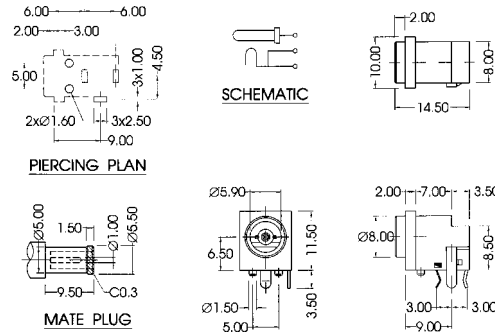

PART NO.	PIN DIA.
DC-270-001	Ø1.05mm

DC-280-0

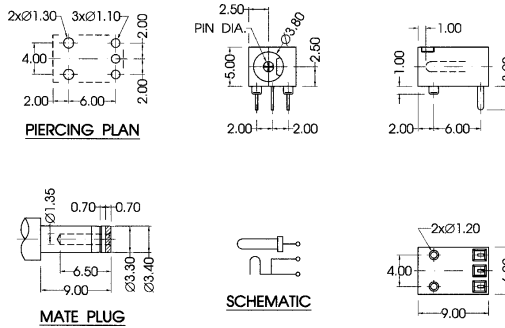

PART NO.	PIN DIA.
DC-280-001	Ø1.00mm
DC-280-002	Ø1.30mm

DC-290-0

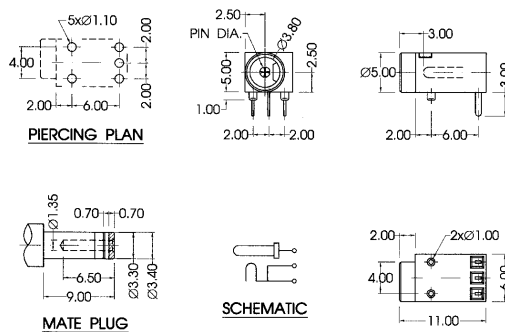

PART NO.	PIN DIA.
DC-290-001	Ø1.00mm
DC-290-002	Ø1.30mm

DC-300-L

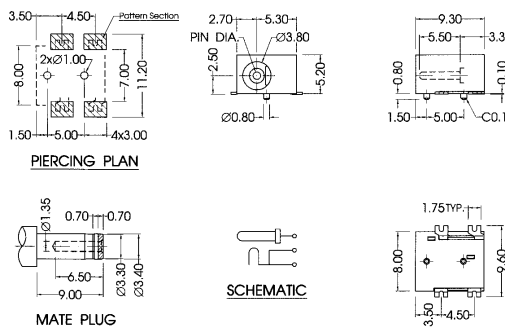

PART NO.	PIN DIA.
DC-300-L01	Ø1.00mm
DC-300-L02	Ø1.30mm

DC POWER JACKS

DK-010-001

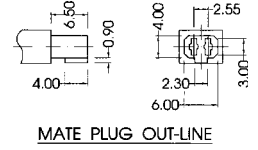
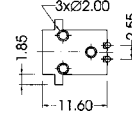
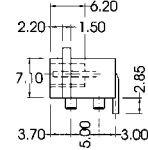
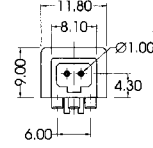
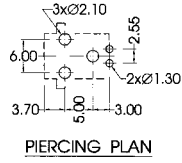

MJ / ST PHONE JACKS EXPLANATION

* BUILD YOUR OWN MJ/ST JACKS ORDER FORMAT *

Fill in all boxes shown with options selected from below.

SERIES		SEQUENTIAL NO.		SLEEVE TYPE	FEATURE	CIRCUIT	EXTEND CIRCUIT	TREATMENT	COLOR OPTION		
S	T	-	1 2	M	-	L	3	0	-	U	3

SERIES:

MJ = Monaural Phone Jacks
ST = Stereo Phone Jacks

SEQUENTIAL NO.:

01-99 Version Specification

SLEEVE TYPE:



Sleeve = O



Sleeve = D



Sleeve = G



Sleeve = M



Sleeve = N



Sleeve = T

FEATURE:

C = Back Cover of Housing
F = Shield Guard Cover
J = Combination Version
L = SMD Surface Mount Version
X = Customer Version
0 = Standard or Nil
1 = With Switches 1P2T
2 = With Switches 2P2T
3-9 = Version Extend

CIRCUIT:

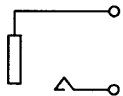

Circuit = 010

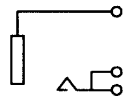

Circuit = 020

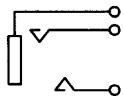

Circuit = 030

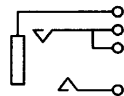

Circuit = 040

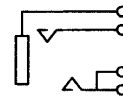

Circuit = 050

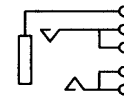

Circuit = 060

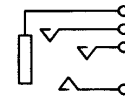

Circuit = 070

EXTEND CIRCUIT:

0 = Standard or Nil
2-9 = Version Extend

COLOR OPTION:

0 = Black	5 = Blue
1 = White	6 = Grey
2 = Red	7 = Orange
3 = Green	8 = Purple
4 = Yellow	9 = Pink

TREATMENT:

0 = Standard Plated
U = Bushing in (Au) Gold Plated
V = Terminal in (Au) Gold Plated
W = Bushing & Terminal in (Au) Gold Plated

REMARKS: For SMD Surface Mount Version, the Reel Carrier Tape Packing is available.
(please consult with **Sun Rise**)

2.5mm MONAURAL PHONE JACKS

MJ-04G-0

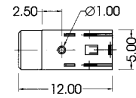
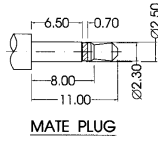
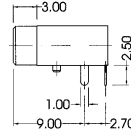
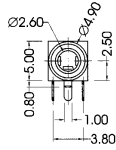
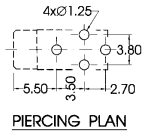

MJ-04G-011		

MJ-05G-0

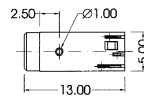
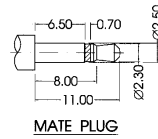
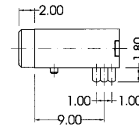
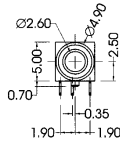
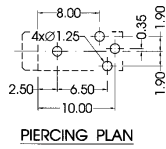

MJ-05G-020		

3.5mm MONAURAL PHONE JACKS

MJ-01M-0

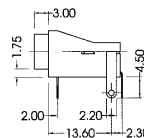
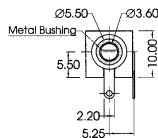
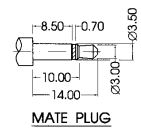
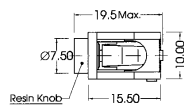
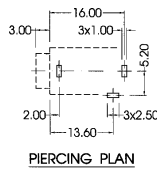

MJ-01M-020		

MJ-01N-0

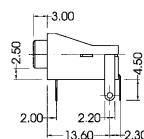
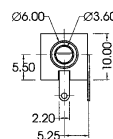
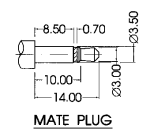
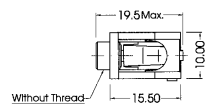
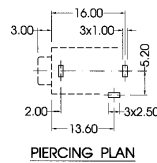

MJ-01N-020		

3.5mm MONAURAL PHONE JACKS

MJ-01T-0

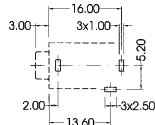

PIERCING PLAN

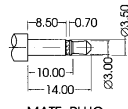
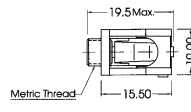

MATE PLUG

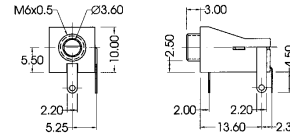

MJ-01T-020		

MJ-02N-0

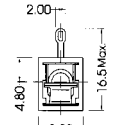

BOTTOM VIEW

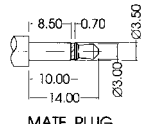
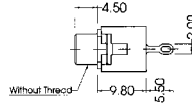

MATE PLUG

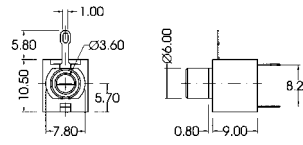

MJ-02N-020		

MJ-02T-0

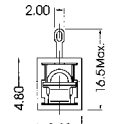

BOTTOM VIEW

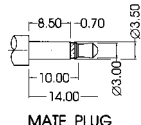
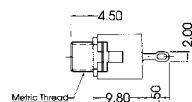

MATE PLUG

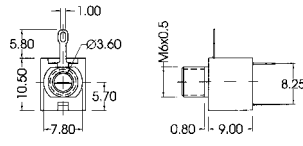

MJ-02T-020		

MJ-030-0

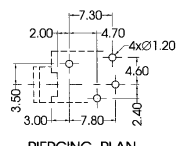

PIERCING PLAN

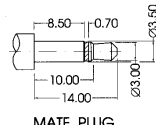
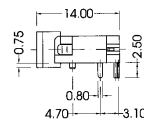
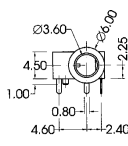

MATE PLUG

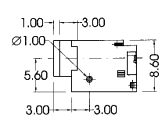

MJ-030-020		

2.5mm STEREO PHONE JACKS

ST-10G-0

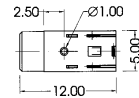
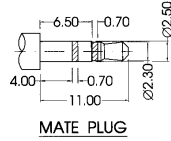
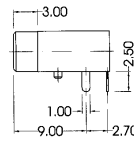
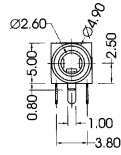
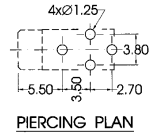

ST-10G-030		

ST-140-0

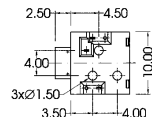
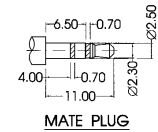
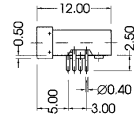
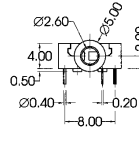
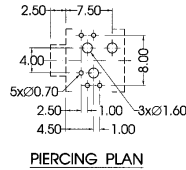

ST-130-010 ST-130-020 ST-130-030		
ST-140-040 ST-140-050 ST-140-060		

AVAILABLE
2001'

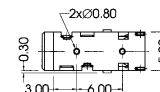
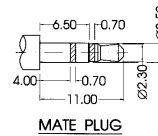
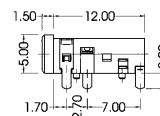
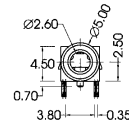
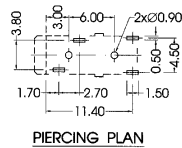

ST-18D-010 ST-18D-020 ST-18D-030		
ST-18D-050		

AVAILABLE
2001'

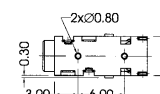
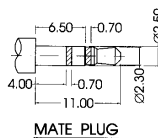
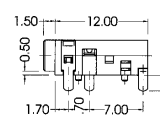
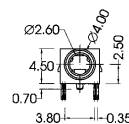
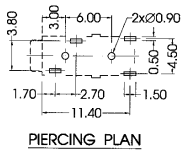

ST-18G-010 ST-18G-020 ST-18G-030		
ST-18G-050		

AVAILABLE
2001'

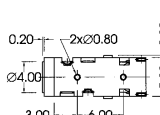
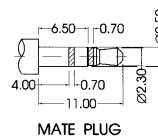
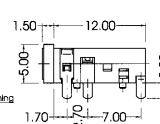
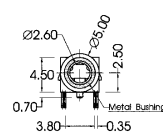
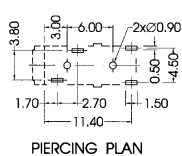

ST-18M-010 ST-18M-020 ST-18M-030		
ST-18M-050		

3.5mm STEREO PHONE JACKS

ST-020-0



PIERCING PLAN

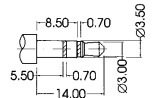
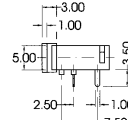
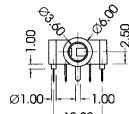

MATE PLUG

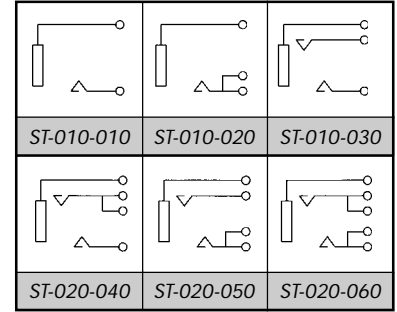
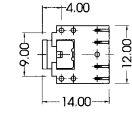

ST-020-C

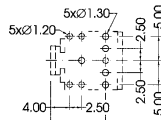

PIERCING PLAN

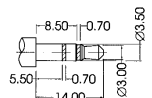
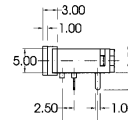
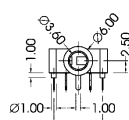

MATE PLUG

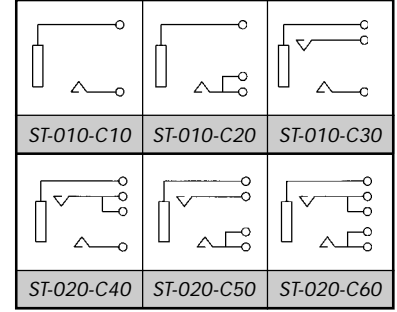
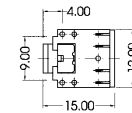

ST-02D-0

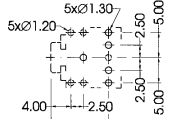

PIERCING PLAN

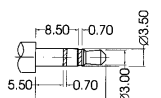
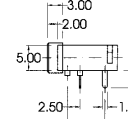
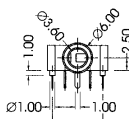

MATE PLUG

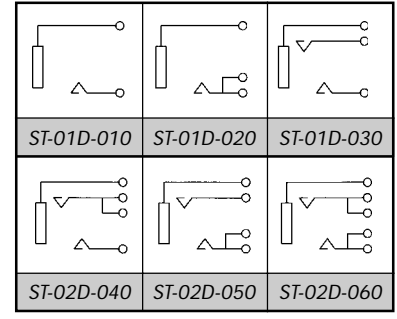
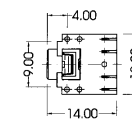

ST-02D-C

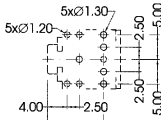

PIERCING PLAN

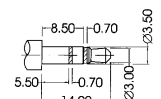
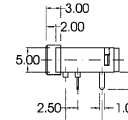
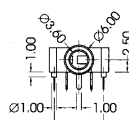

MATE PLUG

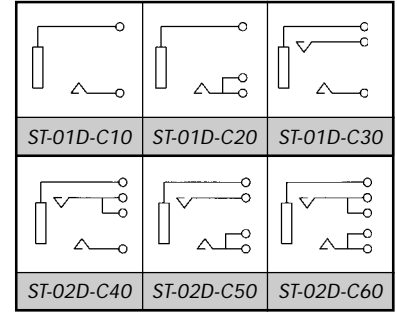
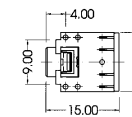

ST-02G-0

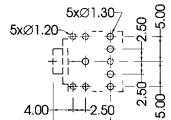

PIERCING PLAN

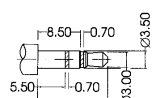
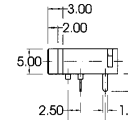
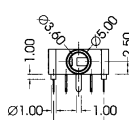

MATE PLUG

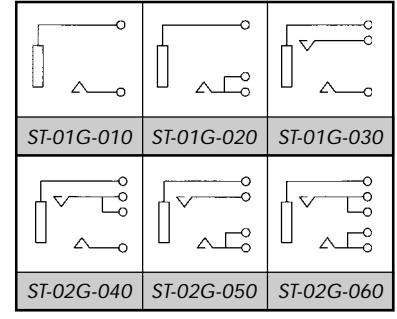
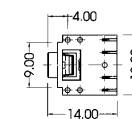

3.5mm STEREO PHONE JACKS

ST-02G-C

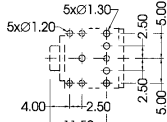

PIERCING PLAN

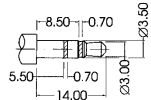
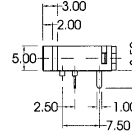
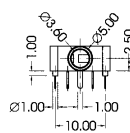

MATE PLUG

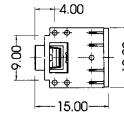

ST-01G-C10	ST-01G-C20	ST-01G-C30
ST-02G-C40	ST-02G-C50	ST-02G-C60

ST-02M-0

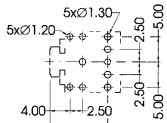

PIERCING PLAN

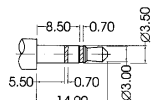
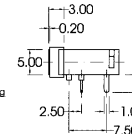
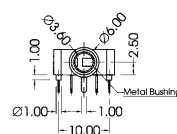

MATE PLUG

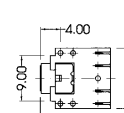

ST-01M-010	ST-01M-020	ST-01M-030
ST-02M-040	ST-02M-050	ST-02M-060

ST-02M-C

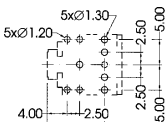

PIERCING PLAN

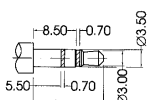
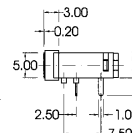
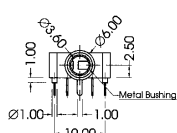

MATE PLUG

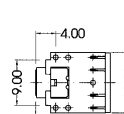

ST-01M-C10	ST-01M-C20	ST-01M-C30
ST-02M-C40	ST-02M-C50	ST-02M-C60

ST-040-1

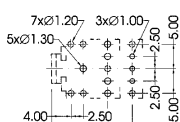

PIERCING PLAN

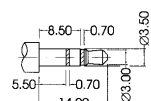
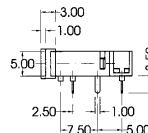
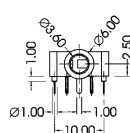

MATE PLUG

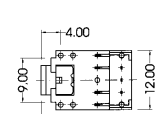

ST-030-110	ST-030-120	ST-030-130
ST-040-140	ST-040-150	ST-040-160

ST-04D-1

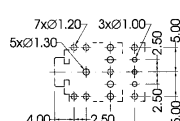

PIERCING PLAN

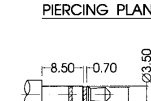
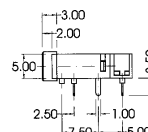
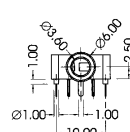

MATE PLUG

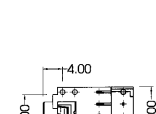

ST-03D-110	ST-03D-120	ST-03D-130
ST-04D-140	ST-04D-150	ST-04D-160

3.5mm STEREO PHONE JACKS

ST-04G-1

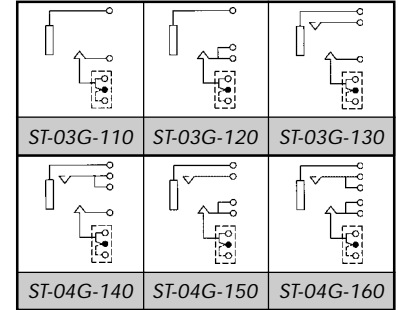
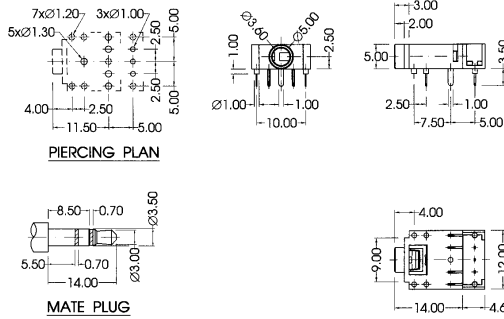

ST-04M-1

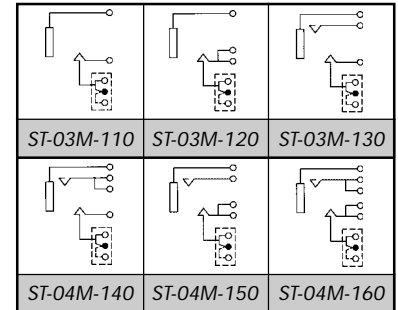
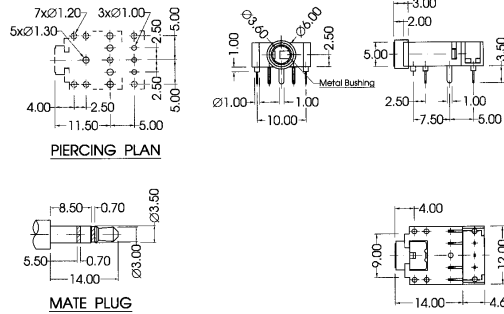

ST-060-2

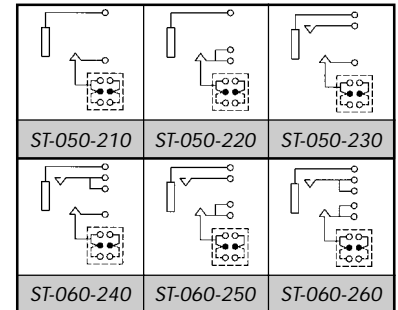
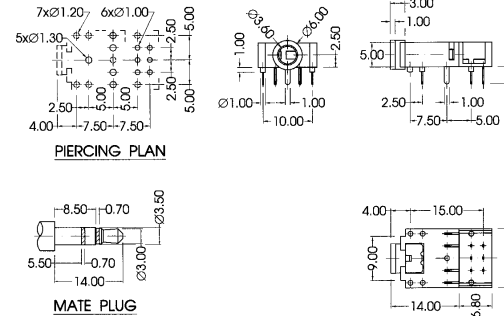

ST-06D-2

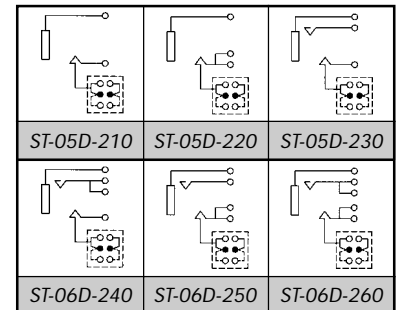
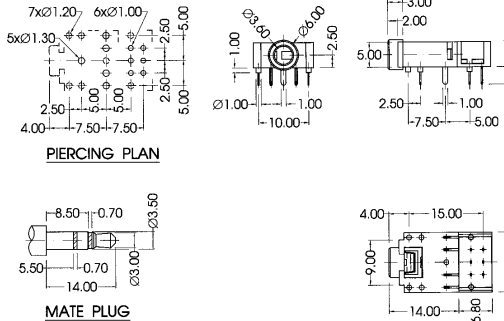

ST-06G-2

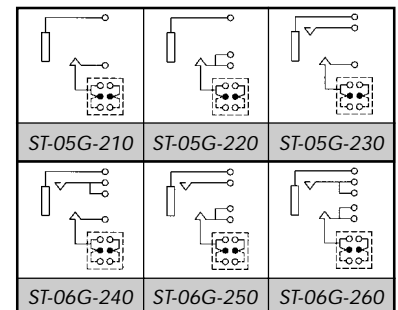
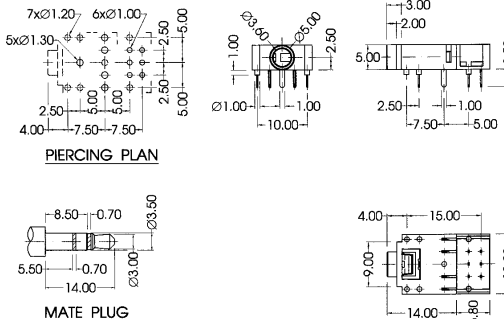

3.5mm STEREO PHONE JACKS

ST-06M-2

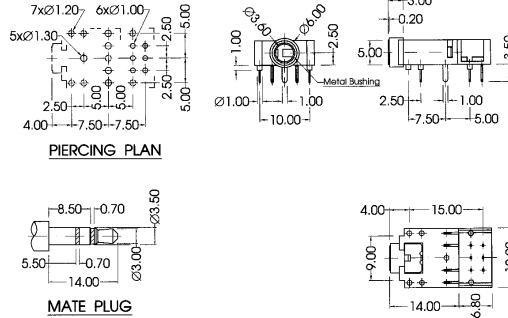

ST-05M-210	ST-05M-220	ST-05M-230
ST-06M-240	ST-06M-250	ST-06M-260

ST-07D-0

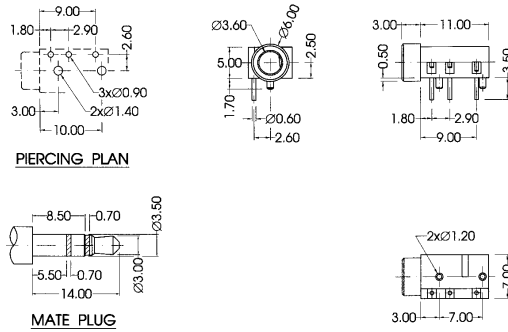

ST-07D-030		

ST-080-0

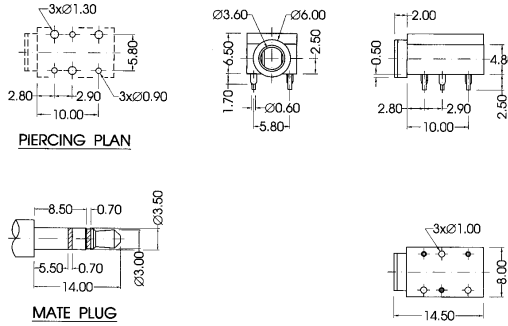

ST-080-030		

ST-09D-0

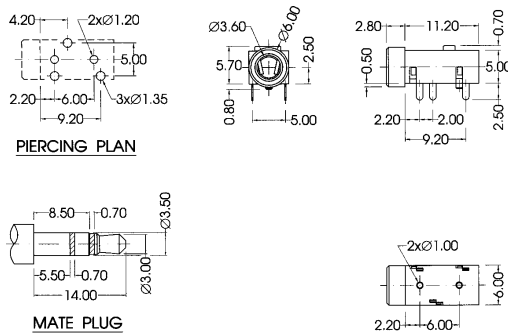

ST-09D-030		

ST-09G-0

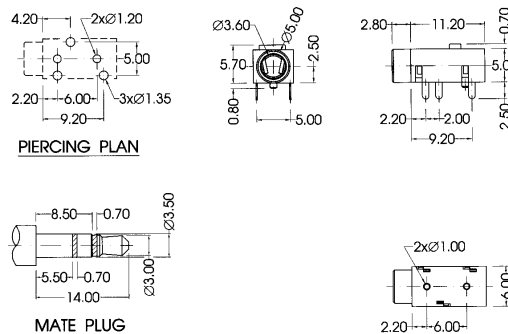

ST-09G-030		

3.5mm STEREO PHONE JACKS

ST-09M-0

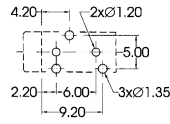

PIERCING PLAN

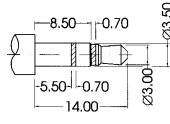
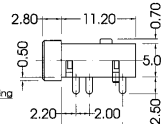
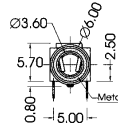

MATE PLUG

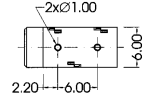

ST-09M-030		

ST-11D-0

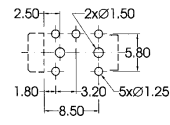

PIERCING PLAN

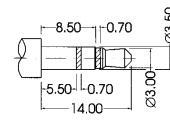
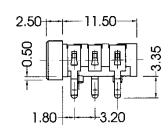
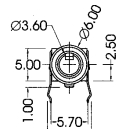

MATE PLUG

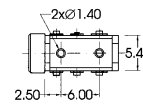

ST-11D-030		

ST-11G-0

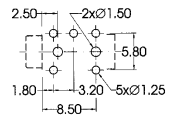

PIERCING PLAN

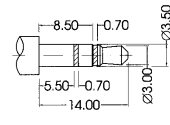
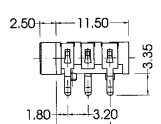
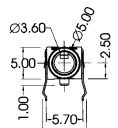

MATE PLUG

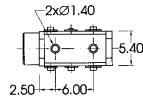

ST-11G-030		

ST-11M-0

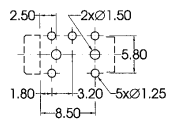

PIERCING PLAN

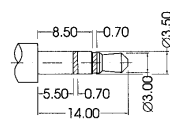
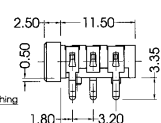
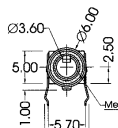

MATE PLUG

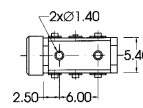

ST-11M-030		

ST-12D-0

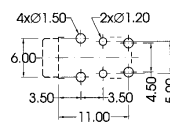

PIERCING PLAN

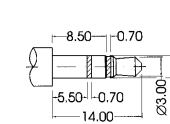
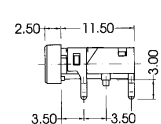
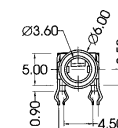

MATE PLUG

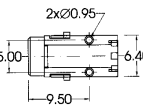

ST-12D-030		

3.5mm STEREO PHONE JACKS

ST-12G-0

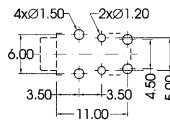

PIERCING PLAN

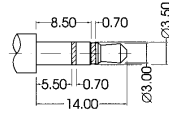
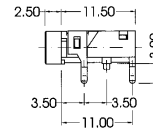
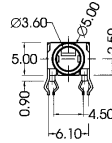

MATE PLUG

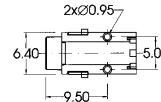

ST-12G-030		

ST-12M-0

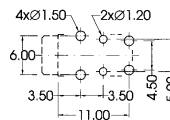

PIERCING PLAN

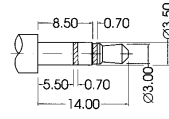
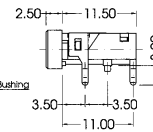
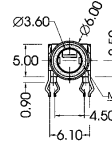

MATE PLUG

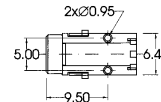

ST-12M-030		

ST-15D-4

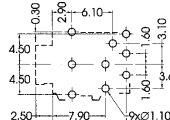

PIERCING PLAN

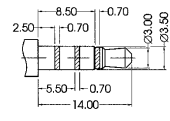
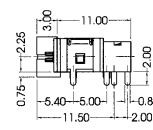
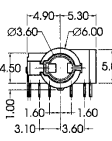

MATE PLUG

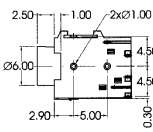

ST-15D-070	ST-15D-370	ST-15D-470
ST-15D-072	ST-15D-372	ST-15D-472

ST-17D-0

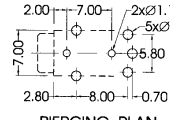

PIERCING PLAN

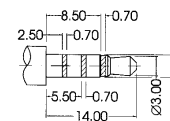
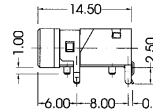
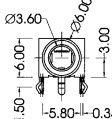

MATE PLUG

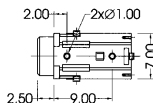

ST-17D-030	ST-17D-070	

ST-19D-0

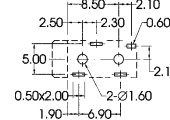

PIERCING PLAN

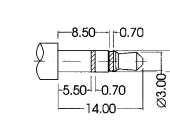
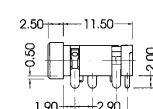
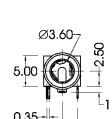

MATE PLUG

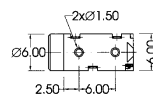

ST-19D-010	ST-19D-020	ST-19D-030
ST-19D-050		

3.5mm STEREO PHONE JACKS

ST-19G-0

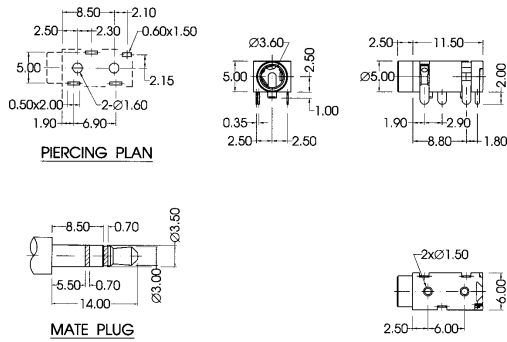

ST-19G-010	ST-19G-020	ST-19G-030
ST-19G-050		

ST-19M-0

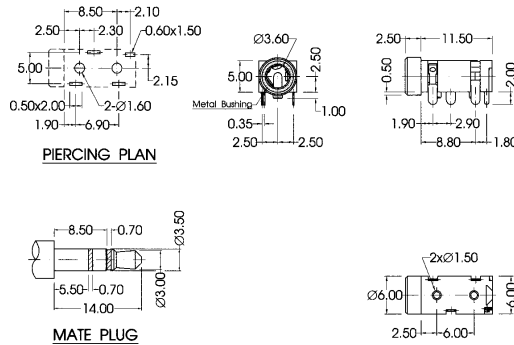

ST-19M-010	ST-19M-020	ST-19M-030
ST-19M-050		

ST-240-0

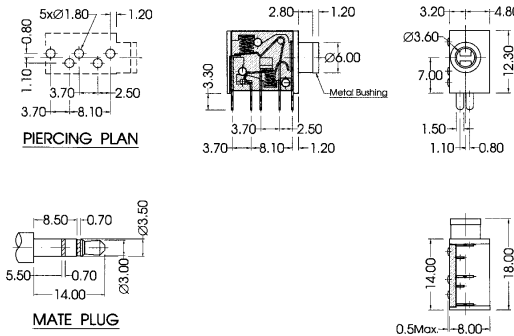

ST-240-010	ST-240-020	ST-240-030
ST-240-040	ST-240-050	ST-240-060

ST-24D-0

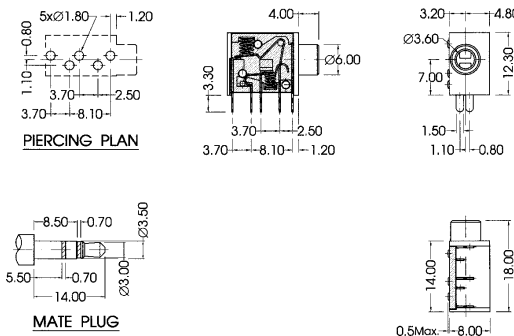

ST-24D-010	ST-24D-020	ST-24D-030
ST-24D-040	ST-24D-050	ST-24D-060

ST-24M-0

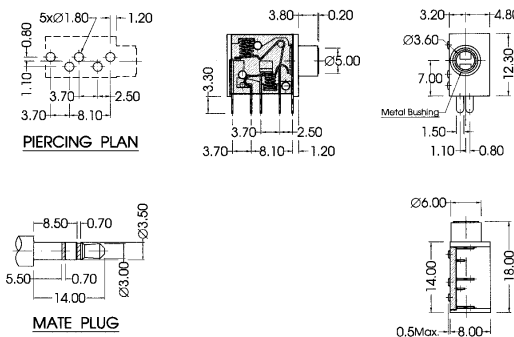

ST-24M-010	ST-24M-020	ST-24M-030
ST-24M-040	ST-24M-050	ST-24M-060

3.5mm STEREO PHONE JACKS

ST-24N-O

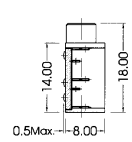
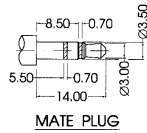
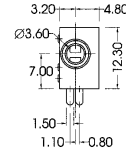
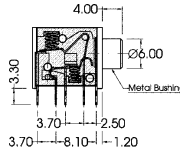
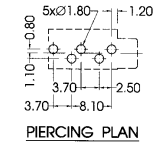

<i>ST-23N-010</i>	<i>ST-23N-020</i>	<i>ST-23N-030</i>
<i>ST-24N-040</i>	<i>ST-24N-050</i>	<i>ST-24N-060</i>

ST-240-F

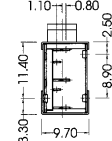
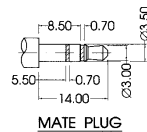
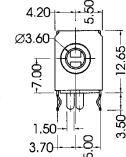
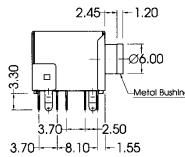
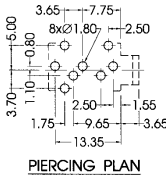

<i>ST-230-F10</i>	<i>ST-230-F20</i>	<i>ST-230-F30</i>
<i>ST-240-F40</i>	<i>ST-240-F50</i>	<i>ST-240-F60</i>

ST-24D-F

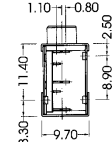
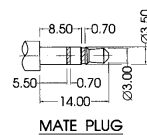
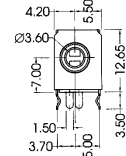
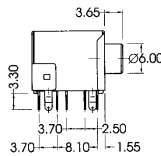
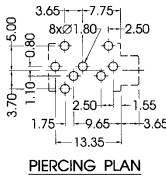

<i>ST-23D-F10</i>	<i>ST-23D-F20</i>	<i>ST-23D-F30</i>
<i>ST-24D-F40</i>	<i>ST-24D-F50</i>	<i>ST-24D-F60</i>

ST-24M-F

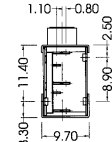
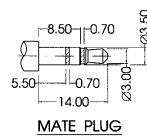
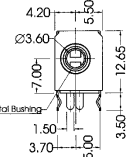
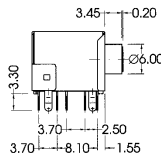
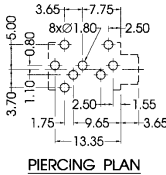

<i>ST-23M-F10</i>	<i>ST-23M-F20</i>	<i>ST-23M-F30</i>
<i>ST-24M-F40</i>	<i>ST-24M-F50</i>	<i>ST-24M-F60</i>

ST-24N-F

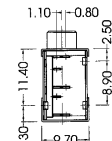
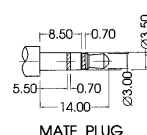
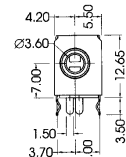
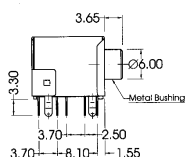
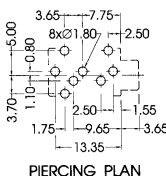

<i>ST-23N-F10</i>	<i>ST-23N-F20</i>	<i>ST-23N-F30</i>
<i>ST-24N-F40</i>	<i>ST-24N-F50</i>	<i>ST-24N-F60</i>

3.5mm STEREO PHONE JACKS

ST-26D-0

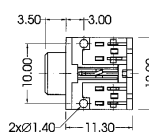
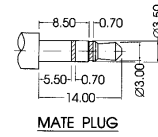
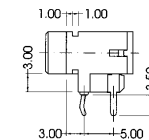
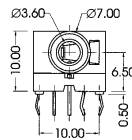
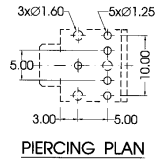

<i>ST-25D-010</i>	<i>ST-25D-020</i>	<i>ST-25D-030</i>
<i>ST-26D-040</i>	<i>ST-26D-050</i>	<i>ST-26D-060</i>

ST-26M-0

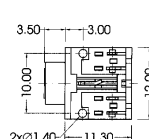
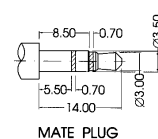
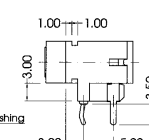
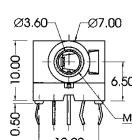
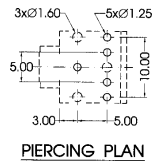

<i>ST-25M-010</i>	<i>ST-25M-020</i>	<i>ST-25M-030</i>
<i>ST-26M-040</i>	<i>ST-26M-050</i>	<i>ST-26M-060</i>

ST-28D-0

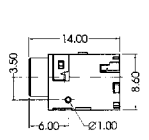
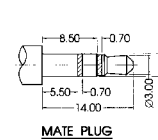
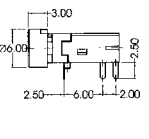
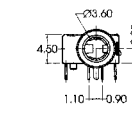
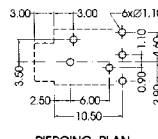

<i>ST-27D-010</i>	<i>ST-27D-020</i>	<i>ST-27D-030</i>
<i>ST-28D-040</i>	<i>ST-28D-050</i>	<i>ST-28D-060</i>

ST-28M-0

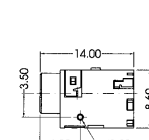
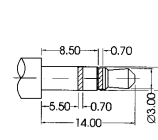
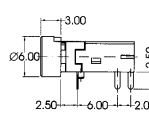
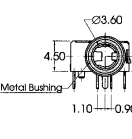
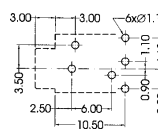

<i>ST-27M-010</i>	<i>ST-27M-020</i>	<i>ST-27M-030</i>
<i>ST-28M-040</i>	<i>ST-28M-050</i>	<i>ST-28M-060</i>

ST-28D-F

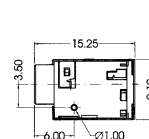
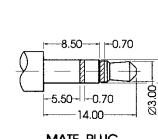
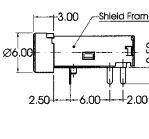
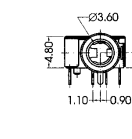
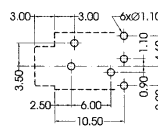

<i>ST-27D-F10</i>	<i>ST-27D-F20</i>	<i>ST-27D-F30</i>
<i>ST-28D-F40</i>	<i>ST-28D-F50</i>	<i>ST-28D-F60</i>

3.5mm STEREO PHONE JACKS

ST-28M-F

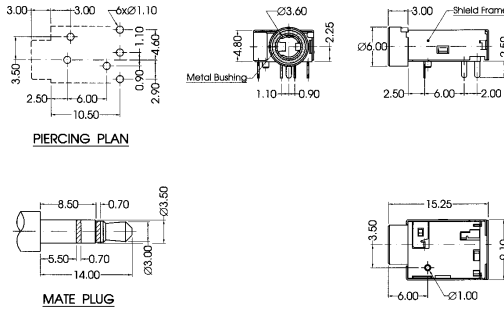

ST-27M-F10	ST-27M-F20	ST-27M-F30
ST-28M-F40	ST-28M-F50	ST-28M-F60

2.5mm STEREO PHONE JACKS / SMT

AVAILABLE
2001'

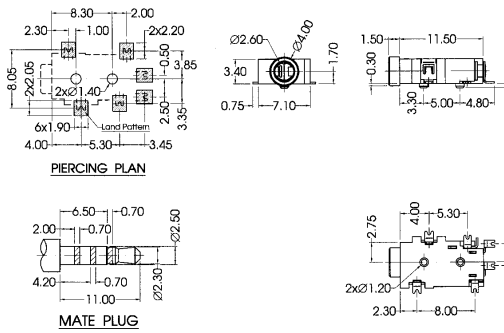

ST-16G-L70	ST-16G-L71	ST-16G-L72
ST-16G-L73		

AVAILABLE
2001'

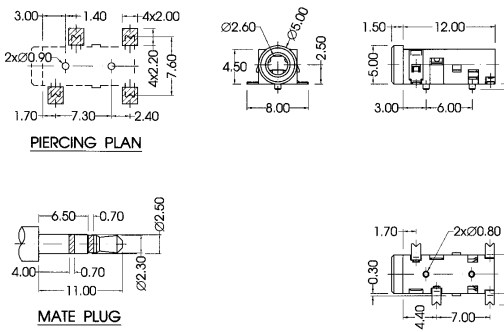

ST-18D-L10	ST-18D-L20	ST-18D-L30
ST-18D-L50		

AVAILABLE
2001'

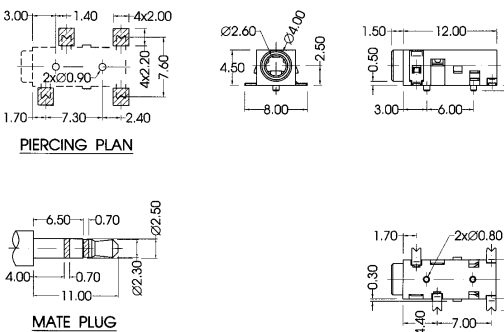

ST-18G-L10	ST-18G-L20	ST-18G-L30
ST-18G-L50		

2.5mm STEREO PHONE JACKS / SMT

AVAILABLE
2001'

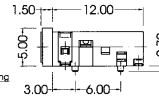
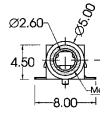
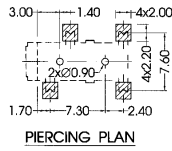

ST-18M-L10	ST-18M-L20	ST-18M-L30
ST-18M-L50		

ST-200-L

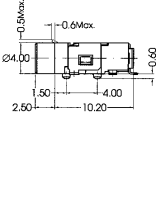
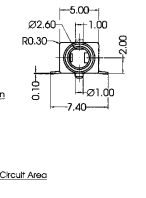
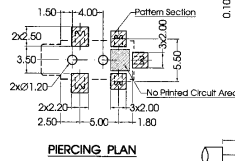

ST-200-L10	ST-200-L20	ST-200-L30
ST-200-L50		

ST-201-L

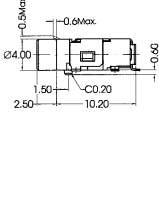
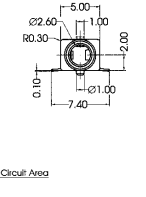
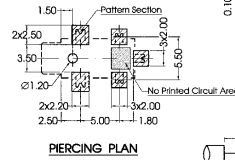

ST-201-L10	ST-201-L20	ST-201-L30
ST-201-L50		

ST-202-L

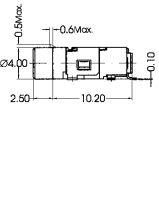
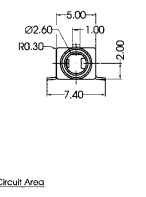
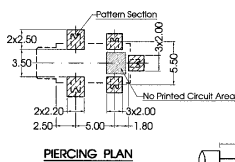

ST-202-L10	ST-202-L20	ST-202-L30
ST-202-L50		

ST-22G-L

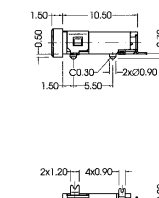
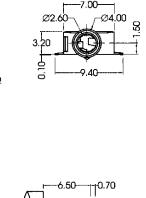
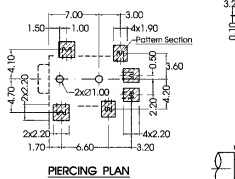

ST-21G-L10	ST-21G-L20	ST-21G-L30
ST-22G-L40	ST-22G-L50	ST-22G-L60

ST-12D-L

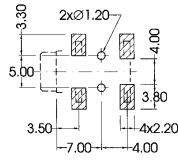

PIERCING PLAN

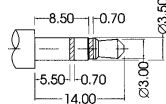

MATE PLUG

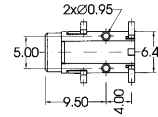
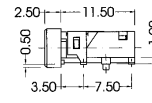
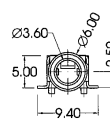

ST-12D-L30		

ST-12G-L

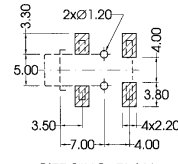

PIERCING PLAN

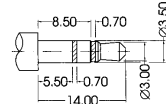

MATE PLUG

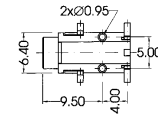
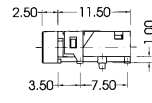
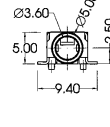

ST-12G-L30		

ST-12M-L

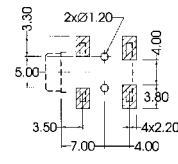

PIERCING PLAN

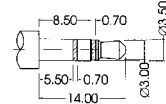

MATE PLUG

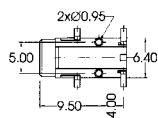
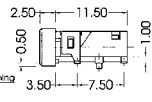
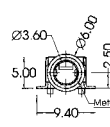

ST-12M-L30		

ST-17D-L

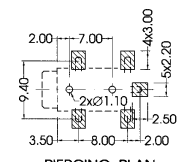

PIERCING PLAN

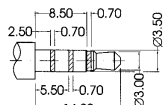

MATE PLUG

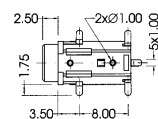
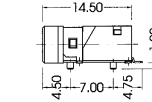
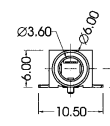

ST-17D-L30	ST-17D-L70	

ST-19D-L

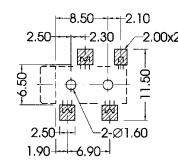

PIERCING PLAN

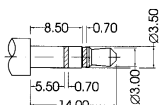

MATE PLUG

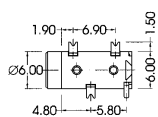
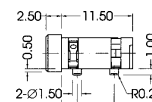
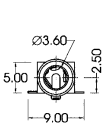

ST-19D-L10	ST-19D-L20	ST-19D-L30
ST-19D-L50		

3.5mm STEREO PHONE JACKS / SMT

ST-19G-L

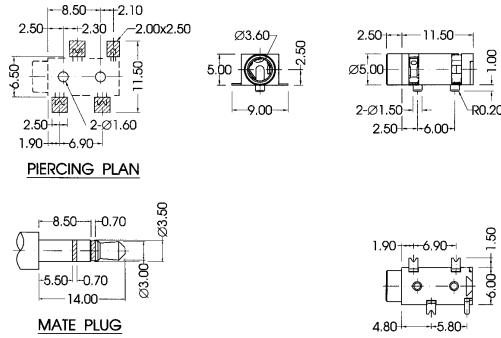

ST-19G-L10	ST-19G-L20	ST-19G-L30
ST-19G-L50		

ST-19M-L

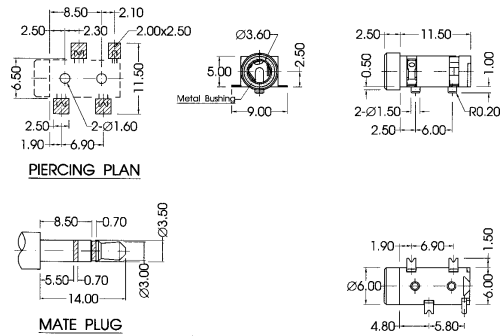

ST-19M-L10	ST-19M-L20	ST-19M-L30
ST-19M-L50		

2.5mm & 3.5mm COMBINATION JACKS

ST-30D-J

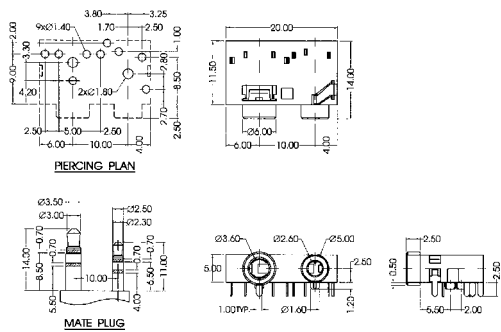

ST-29D-J10	ST-29D-J20	ST-29D-J30
ST-30D-J40	ST-30D-J50	ST-30D-J60

ST-30M-J

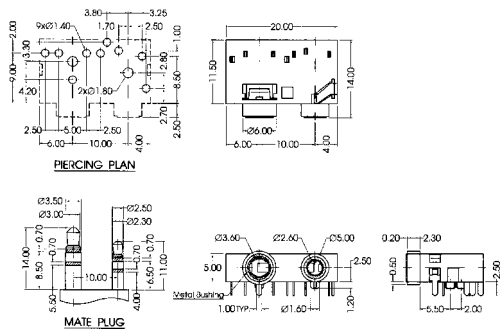

ST-29M-J10	ST-29M-J20	ST-29M-J30
ST-30M-J40	ST-30M-J50	ST-30M-J60