



PRODUCT DATASHEET

HighBay series

last update 15/2/2018

DETAILS

Product Number	FP16310_HB-2X2MXS-M
Family	HighBay
Type	Assembly
Color	clear
Diameter	90 x 90 mm
Height	18,00 mm
Style	square
Optic Material	
Holder Material	
Fastening	screw
Status	production ready
ROHS Compliant	Yes
Date Updated	15/02/2018



OPTICAL PROPERTIES

LED	Viewing Angle	Light Beam	Efficiency	cd/lm	Connector
CLU700/701	sim: 29	Medium	sim: 88 %	sim: 2.207	Bender Wirth: 434 Typ 2x2MX HV
MHB-A/B	sim: 24	Medium	sim: 90 %	sim: 2.700	-
LUXEON M/MX	sim: 0	Medium	-	sim: 0.000	-

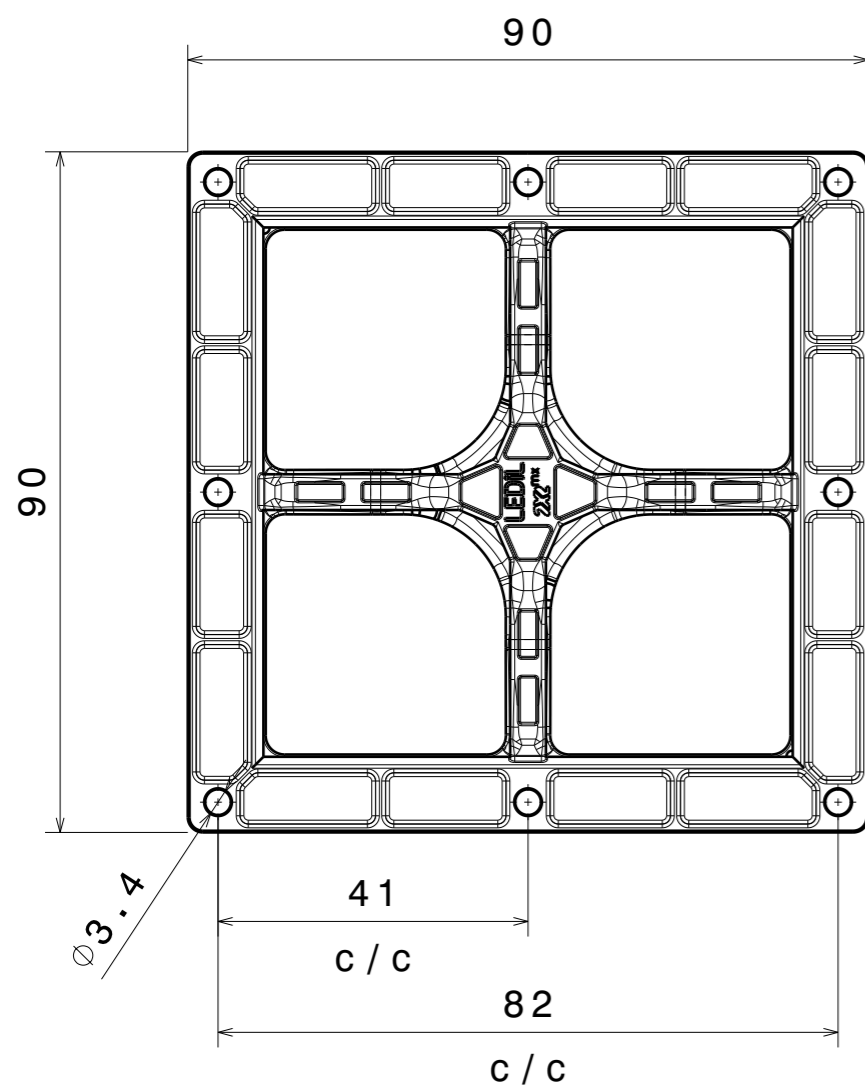

Top view

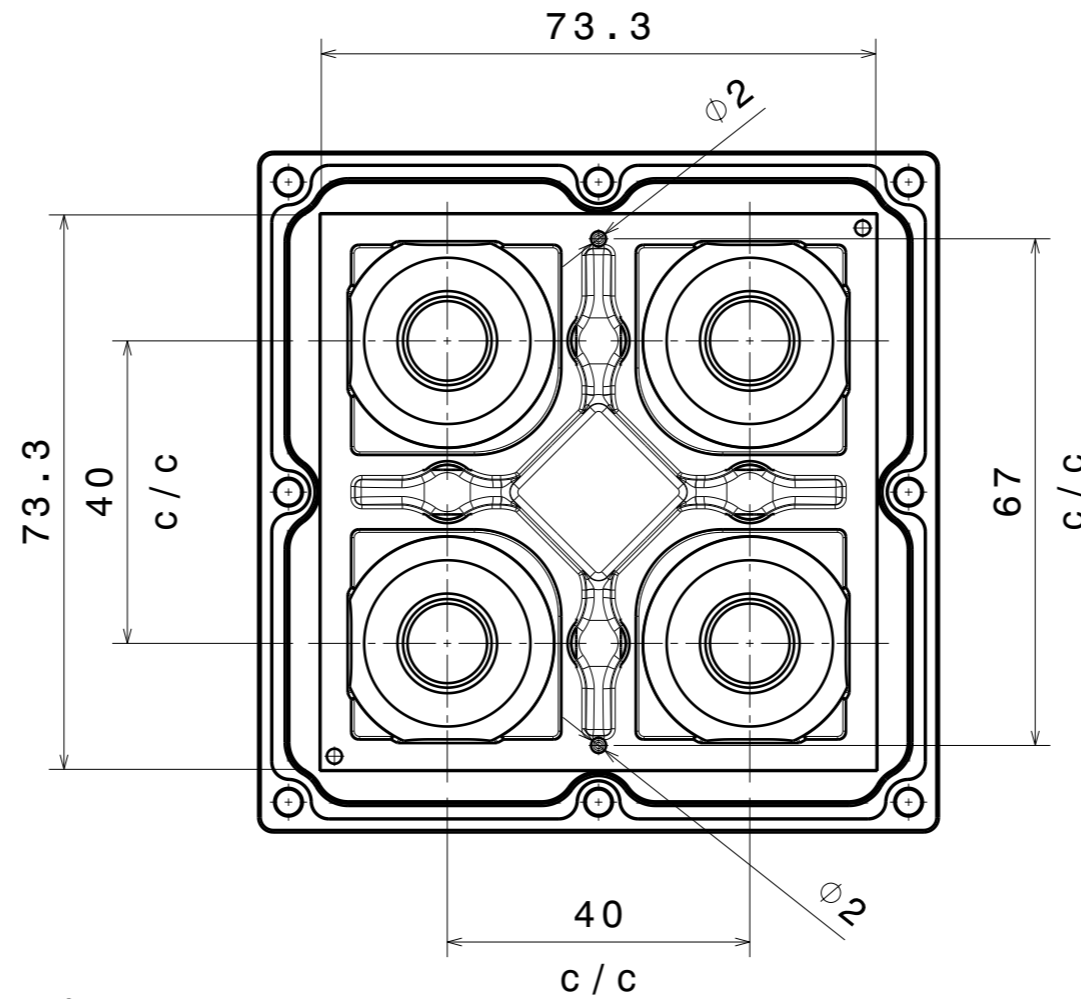

Bottom view

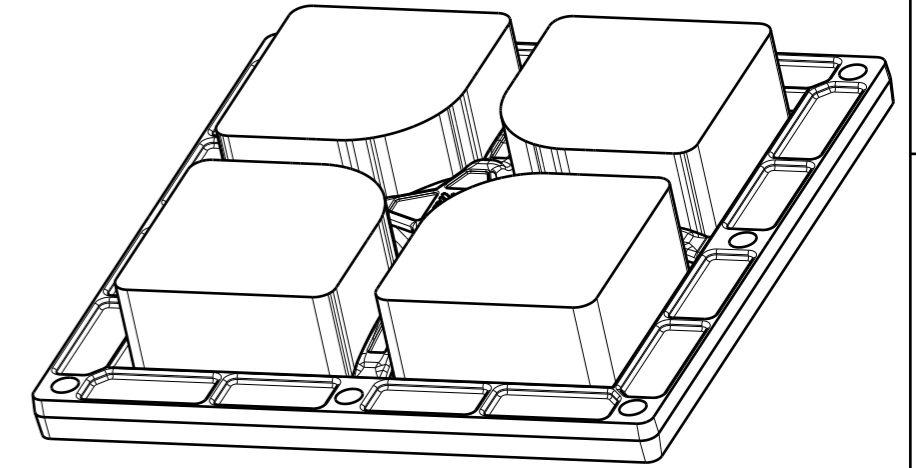

Isometric view

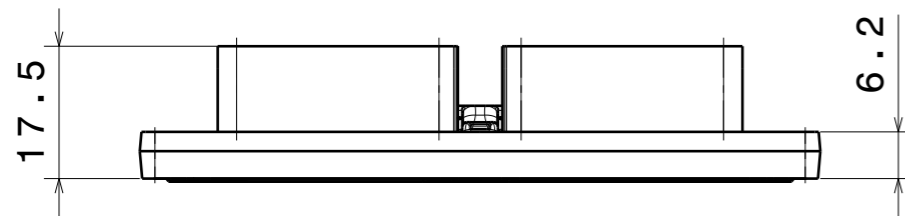

Front view

FP16310_HB-2X2MXS-M

COMPONENTS

INDEX	PART	TYPE	MATERIAL	COLOR / COATING
1	F15903_HB-2x2MXS-M		Silicone	
2	F14813_STRADA-2X2MXS-FRAME		Nylon	black

MECHANICAL DRAWING		LEDiL®
PRODUCT STRADA-MAXI		
Plastic moulding general tolerances according to DIN 16901-130 and applies if not otherwise shown in the drawing. Silicone moulding general tolerances according to ISO 3302-1 Class M3 and applies if not otherwise shown in the drawing.	FIRST ANGLE PROJECTION: 	This drawing is the property of LEDiL Oy. It may not be copied or otherwise distributed without prior written permission from LEDiL Oy.
SCALE 1:1	WEIGHT 64 g	A3 SHEET 1/1

Luminaire: Ledil Oy FP16310_HB-2X2MXS-M_(CLU701)_SIMULATED
Lamps: 1 x Citizen CLU701

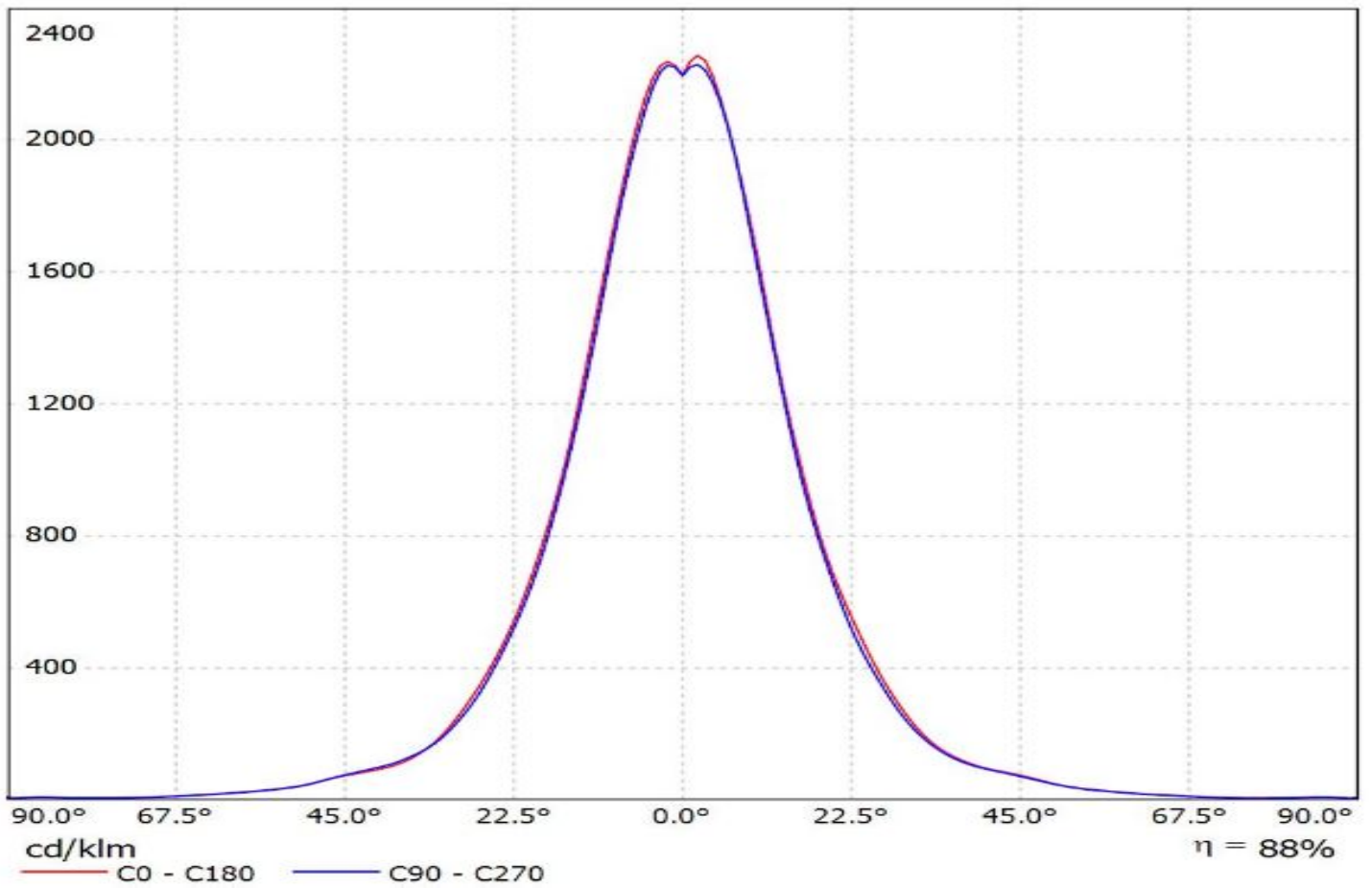

Luminaire: Ledil Oy preliminary_FP16310_HB-2X2MXS-M_SIMULATED

Lamps: 1 x CREE_MHB-B

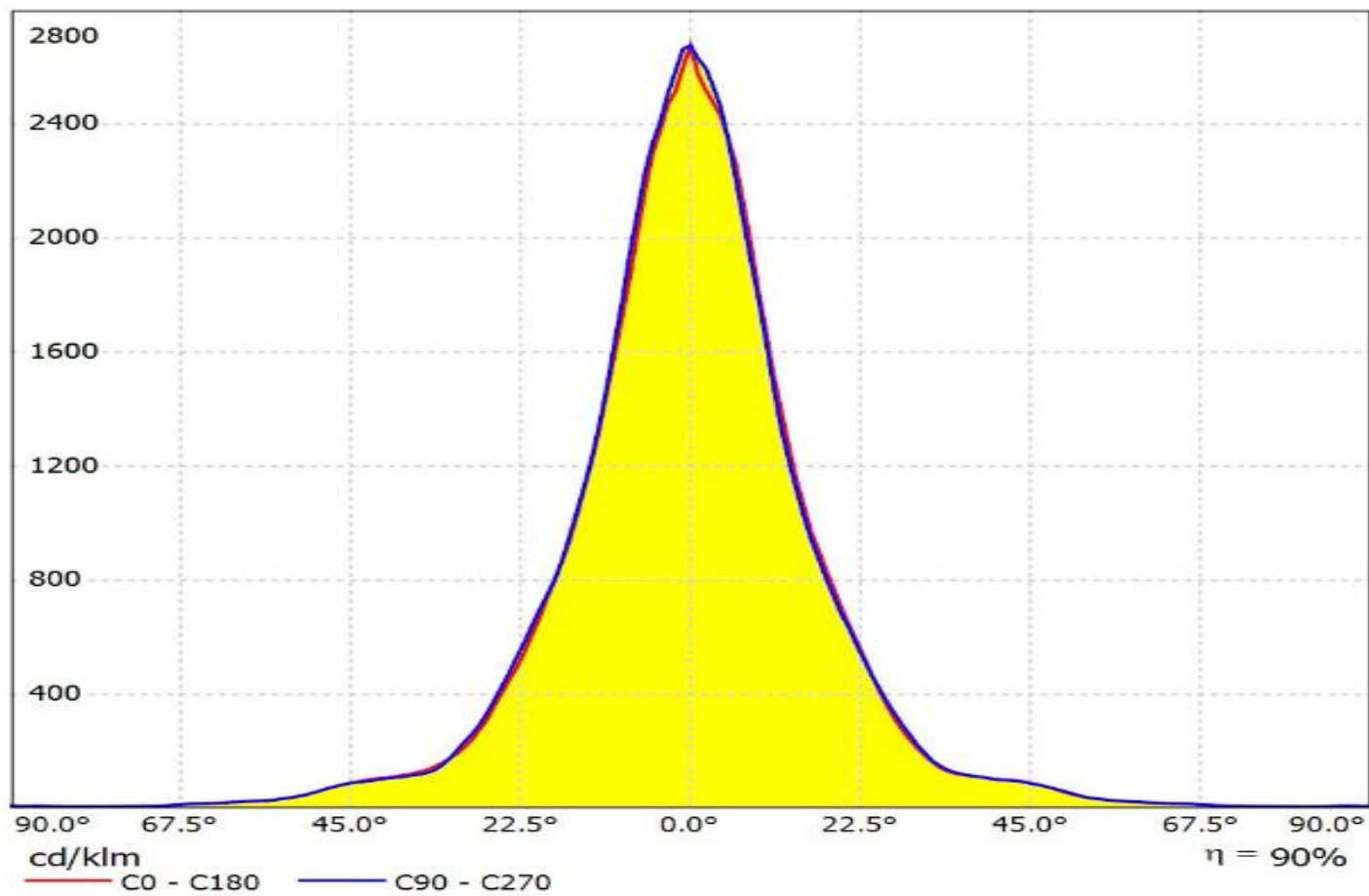

Luminaire: Ledil Oy FP16310_HB-2X2MXS-M_(CLU701)_SIMULATED

Lamps: 1 x Citizen CLU701

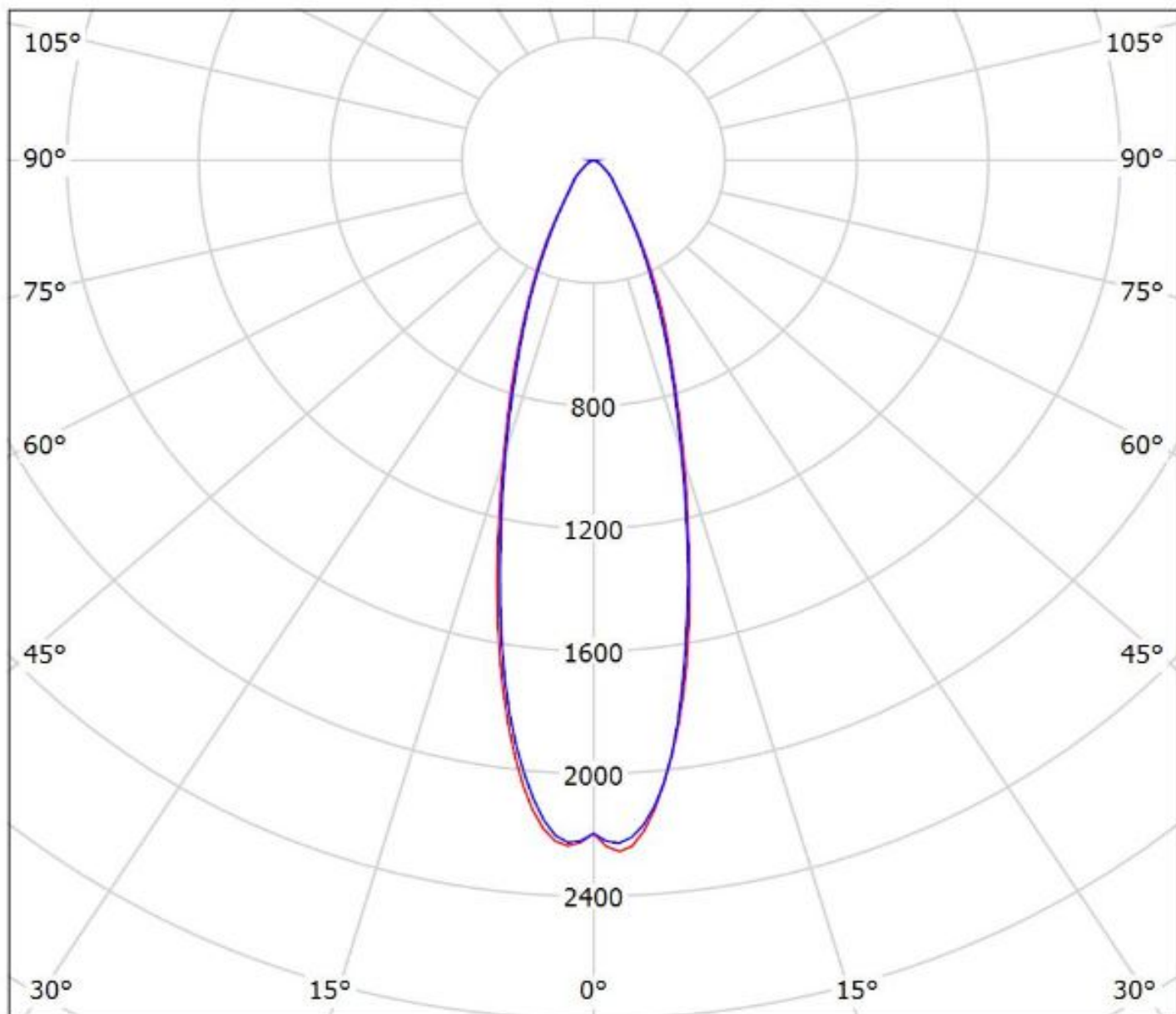

cd/klm

— C0 - C180 — C90 - C270

$\eta = 88\%$

Luminaire: Ledil Oy preliminary_FP16310_HB-2X2MXS-M_SIMULATED

Lamps: 1 x CREE_MHB-B

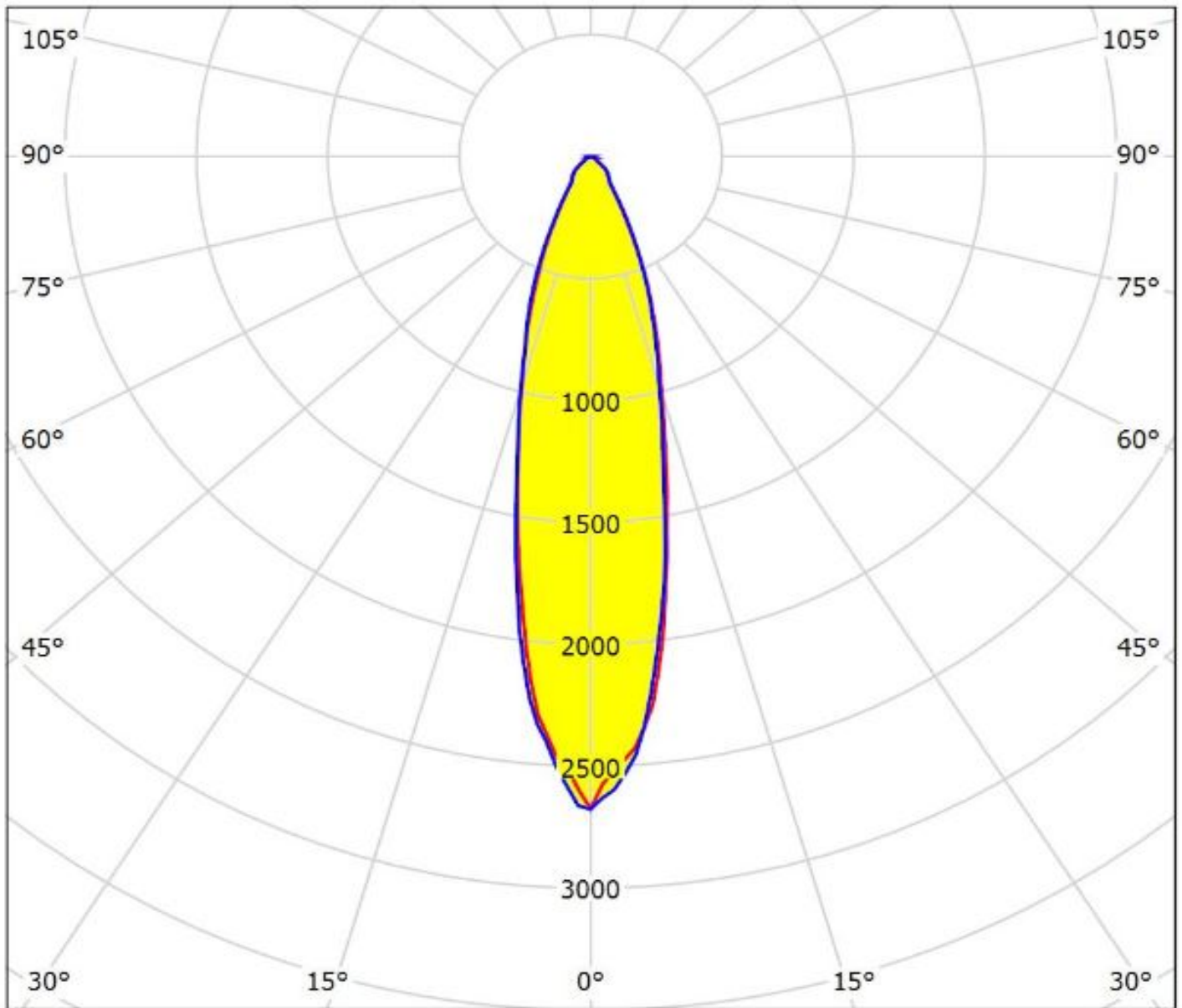

cd/klm

— C0 - C180

— C90 - C270

$\eta = 90\%$

NOTE: The typical divergence will be changed by different color, chip size and chip position tolerance. The typical total divergence is the full angle measured where the luminous intensity is half of the peak value.

GENERAL INFORMATION

- Product series especially designed & optimized for series of LEDs.
- Special care taken to make light distribution as uniform as possible.

Note! Due to use of high power COB's with this product, special attention to proper thermal design is highly recommended. LEDiL has no liability for direct, indirect or consecutive damages arising from the LEDiL products being used outside of the recommended temperature range.