

Rev.	Description	Date
A0	New release	2017.10.16

### 1. PHYSICAL CHARACTERISTICS (mm)

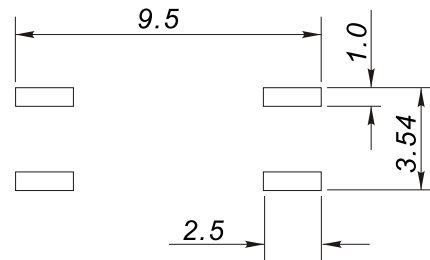
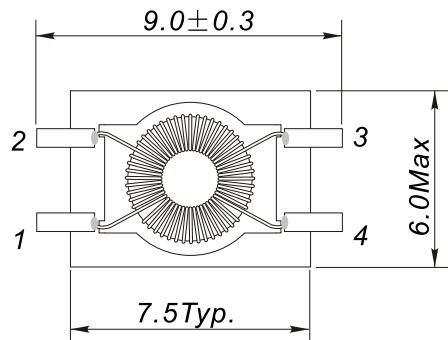
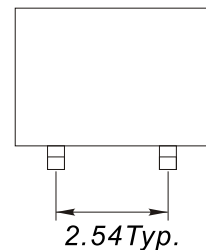
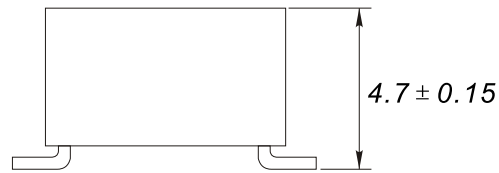

Suggest PCB Layout

### 2. ELECTRONICAL SCHEMATIC

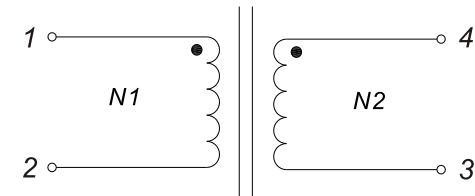

### 3. ELECTRONICAL SPECIFICATIONS

Inductance: 1.0mH Min@10KHz,0.1V

Lk: 0.35uH Max@10KHz,0.1V

DCR: 0.35Ω Max

Retad current: 700mA Max

Operating temperature: -40°C to +105°C

Sotrage temperature: -40°C to +85°C

Note:

1. Solderability: leads shall meet MIL-STD-202, Method 208D for solderability.
2. Flammability: UL94V-0
3. ASTM oxygen index: >28%

#### NOTES:

Temp 25°C 48%RH  
RoHS Compliant

#### GENERAL TOLERANCE

x.x ±0.30  
x.xx ±0.20  
x.xxx ±0.10

NAME:	Common mode choke		
CUSTOMER P/N:		DATE:	2017-10-16
SHINHOM P/N:	L-KLS18-PF0904-102Y	REV:	A0
DRAWN BY:	CHECKED BY:	APPROVE BY:	