



**SPECIFICATIONS**

Rated Current:3.0AMP  
 Contact Resistance:20mΩ Max  
 Withstand Voltage:1000V AC/DC  
 Insulation Resistance:1000MΩ Min  
 Operation Temperature:-40°C to +105°C

Contact Material:Brass  
 Contact Plating:Au Or Tin Over Ni  
 Insulator Material:Polyester(UL94V-0)  
 Standard: PA6T  
 Max.Processing Temp: 230°C for 30-60 seconds  
 (260°C for 10 seconds)

Recommended P.C.B Layout(Top Side)  
 (PCB BOARD TOLERANCE±0.05)

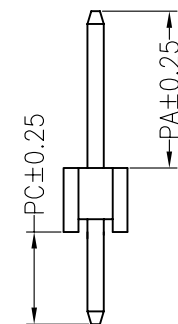
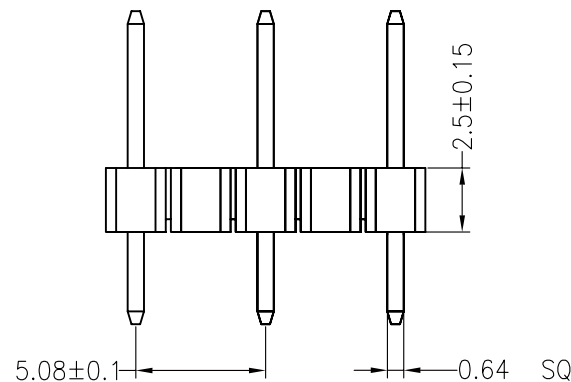
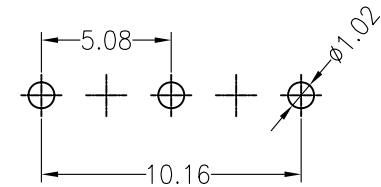
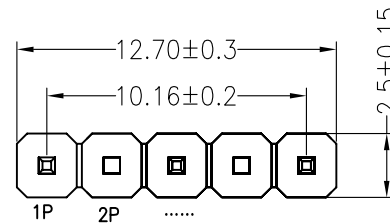

Dimension antitheses list			
ITEM	PA	PC	L
Standard	6.00	3.00	11.50
Alternate			

					OPERATION		DRAW	YiYuSheng	12.03.28	SCALE	FIT	NINGBO KLS ELECTRONIC CO.,LTD.	
				X.X	±0.30	UNIT							
				X.XX	±0.20	CHECK				SIZE	A4	PART NO.	L-KLS1-207-1-5P2K-S
A0	2012.03.28	NEW DRAWING		X.XXX	±0.10	APPROVE				SHEET	1/1		
REV	DATE	MODIFICATION DESCRIPTION		CHANGE	Angle	±3'				PROJ.	◆	TITLE:	2.54mm Pin Header 2.5mm Single 180°