

Load Cell HM9B



Products specification

- HM9B load cell are available in the capacities 10t to 50t. And the customized capacity is available by request.
- Alloy steel construction, nickel plated, hermetically welded, oil-proof, waterproof and anti-corrosive gas and medium making it suitable for all kinds of environments.
- Dual shear beam, Suitable for electronic truck scales, railway scales and other electronic weighing devices.
- It is safety and anti-explosion product that can be used in atrocious weather and hazardous areas.

Features

- High accuracy.
- Alloy steel construction.
- Easy installation, reliable performance.
- With OIML approval.

Specifications

Capacity	t	10/20/25/30/40SE/40/50				
Accuracy		C1	C2	C3	A5M	B10M
Approvals				OIML R60 C3		
Maximum number of verification intervals	n max	1000	2000	3000	5000	10000
Minimum load cell verification interval	v min	E _{max} /3000	E _{max} /5000	E _{max} /7500	E _{max} /15000	E _{max} /10000



Combined error	(%FS)	$\leq \pm 0.050$	$\leq \pm 0.030$	$\leq \pm 0.020$	$\leq \pm 0.026$	$\leq \pm 0.050$
Creep	(%FS/30min)	$\leq \pm 0.038$	$\leq \pm 0.024$	$\leq \pm 0.016$	$\leq \pm 0.017$	$\leq \pm 0.040$
Temperature effect on sensitivity	(%FS/10□)	$\leq \pm 0.028$	$\leq \pm 0.017$	$\leq \pm 0.011$	$\leq \pm 0.013$	$\leq \pm 0.040$
Temperature effect on zero	(%FS/10□)	$\leq \pm 0.047$	$\leq \pm 0.023$	$\leq \pm 0.015$	$\leq \pm 0.014$	$\leq \pm 0.020$
Output sensitivity	(mv/v)	2.0 ± 0.002	2.3 ± 0.002	2.4 ± 0.002	1.9 ± 0.002	1.8 ± 0.002
Input resistance	(Ω)	700 ± 7			775 ± 5	750 ± 7
Output resistance	(Ω)	700 ± 7				
Insulation resistance	(M Ω)	$\geq 5000(50VDC)$				
Zero balance	(%FS)	1.5				
Temperature, compensated	(□)	-10 ~ +40				
Temperature, allowed	(□)	-35 ~ +65				
Excitation, Recommended	(V)	5 ~ 12(DC)				
Excitation, Max	(V)	18(DC)				
Safe overload	(%FS)	150				
Ultimate overload	(%FS)	300				

Outline Dimension mm(inch)



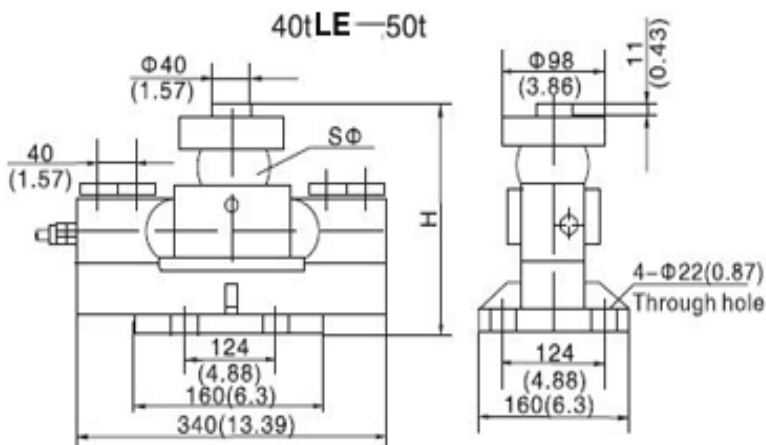
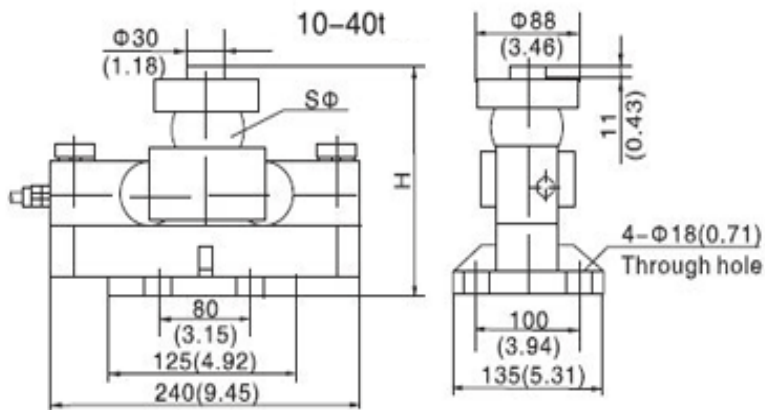

Capacity	10t	20t-40t	40tLE-50t
Dimension			
H	195 (7.68)	225 (8.86)	267 (10.51)
SΦ	50 (1.97)	76 (2.99)	82 (3.22)

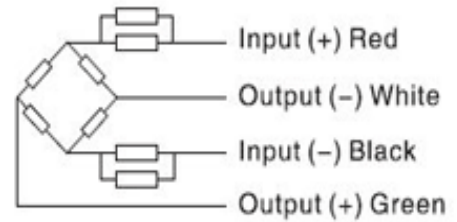

Wiring:

Adopt shielded, 4 conductor cable: $\Phi 5.5\text{mm}$
Standard cable length: 12m

