

ATTENUATORS

Type N, up to 4 GHz, 150 Watts

SPECIFICATIONS:

Models: XN150W-XX, XN150W-XXF, XN150W-XXM

RoHS
Compliant

AEROFLEX
A passion for performance.

Electrical:

Frequency Range _____ DC - 4.0 GHz
 Standard Freq. Values _____ 2.5 & 4 GHz
 Standard dB Value _____ 3, 6, 10, 20, 30 & 40 dB
 Attenuation Accuracy DC - 1.5 GHz 1.5 - 2.5 GHz 2.5 - 4 GHz
 3 & 6 dB _____ ±0.50 dB _____ ±1.0 dB _____ ±1.5 dB
 10 & 20 dB _____ ±0.50 dB _____ ±.75 dB _____ ±1.0 dB
 30 & 40 dB _____ ±0.75 dB _____ ±1.0 dB _____ ±1.5 dB
 Input VSWR (Max.) _____ 1.15:1 _____ 1.25:1 _____ 1.35:1
 Input Power _____ 150 Watts Avg. @ +25°C
 Derated Linearly to 30 Watts @ +125°C
 Peak Power _____ 2 kW Max.
 (5µSec Pulse, .05% Duty Cycle)
 Impedance _____ 50 Ohms
 Operating Temp. Range _____ -54°C to +125°C

Mechanical:

Type N Connectors _____ Passivated Stainless Steel
Mates with MIL-STD-348
 Conductors _____ Gold Plated Beryllium Copper
 Housing _____ Anodized Aluminum

Custom Mtg. hole Config.
may be Added to this
Surface

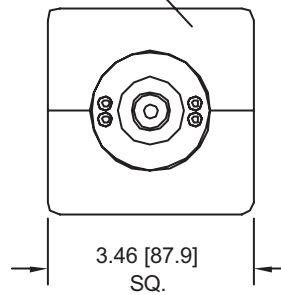

END VIEW
TYPICAL

Units must be Mounted in such a way as to
Allow for Free Air Flow Around fins to Assure
Performance

Note: Units are Unidirectional, Therefore Input Connector MUST be specified & will be Indicated on Unit

Model Number: **XN150W-30**

Male/Female Connectors
 Length: 6.36 ±.05 [161.5 ±1.3]
 Pictured

Model Number: **XN150W-30F**

Female/Female Connectors
 Length: 6.45 ±.05 [163.8 ±1.3]

Model Number: **XN150W-30M**

Male/Male Connectors
 Length: 6.28 ±.05 [159.5 ±1.3]

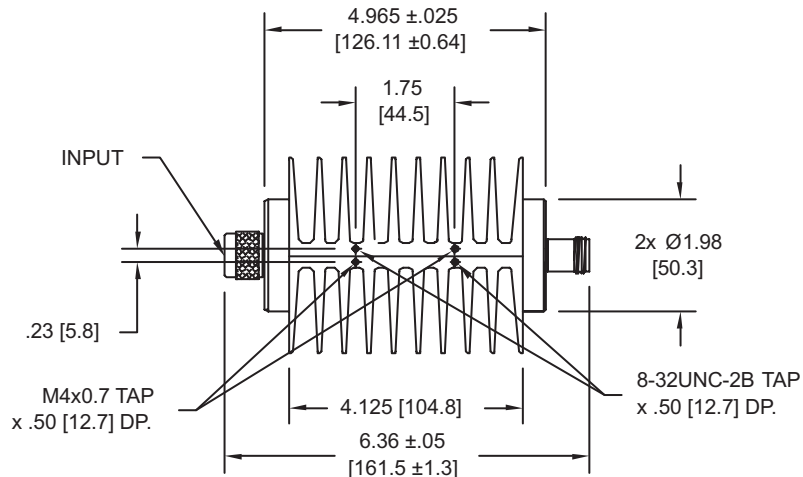

HOW TO ORDER:

Model Number: **XN150W-30Y**

Freq. Range _____
 2 = DC - 2.5 GHz
 4 = DC - 4 GHz

Connector Configuration
 = Male/Female
 F = Fem/Fem
 M = Male/Male

Ordering Examples:

Model Number: **4N150W-30**
 DC - 4 GHz, 30 dB; Type N - Male/Fem

Model Number: **2N150W-30F**
 DC - 2.5 GHz, 30 dB; Type N - Fem/Fem

Note: Dimensions in Brackets are Expressed in Millimeters and are for Reference Only.
 Design, specifications are subject to change without notice. Contact factory for technical
 specifications before purchasing and/or use.

XN150W-ATT: REV F

AEROFLEX
INMET

Aeroflex / Inmet, Inc. • 300 Dino Drive, Ann Arbor, MI 48103 • U.S.A.
 888-244-6638 or 734-426-5553 • FAX: 734-426-5557
 www.aeroflex-inmet.com • sales@aeroflex-inmet.com