

Model: CZL803

Capacity: 0.5-10t / 0.5-20Kib

FEATURES:

Alloy steel structure; Glue sealing IP67

APPLICATIONS:

Electronic platform scales, vehicle scales, railroad scales etc.

WIRING SCHEME:

| | | | | | | | |
|-------|-----------|---------|------------|---------|-----------|---------|------------|
| Red + | (Input +) | White - | (Output -) | Black - | (Input -) | Green + | (Output +) |
|-------|-----------|---------|------------|---------|-----------|---------|------------|

It uses 4-core shielded cable (φ5.8×3000mm). The length of the cable can be adjusted according to clients' requests, but we suggest to use this standard length to ensure the output precision.

LOAD INSTRUCTION:

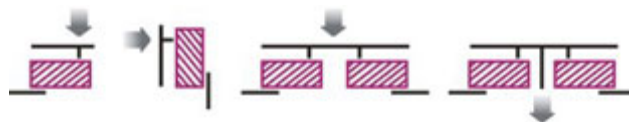

DIMENSIONS(mm):

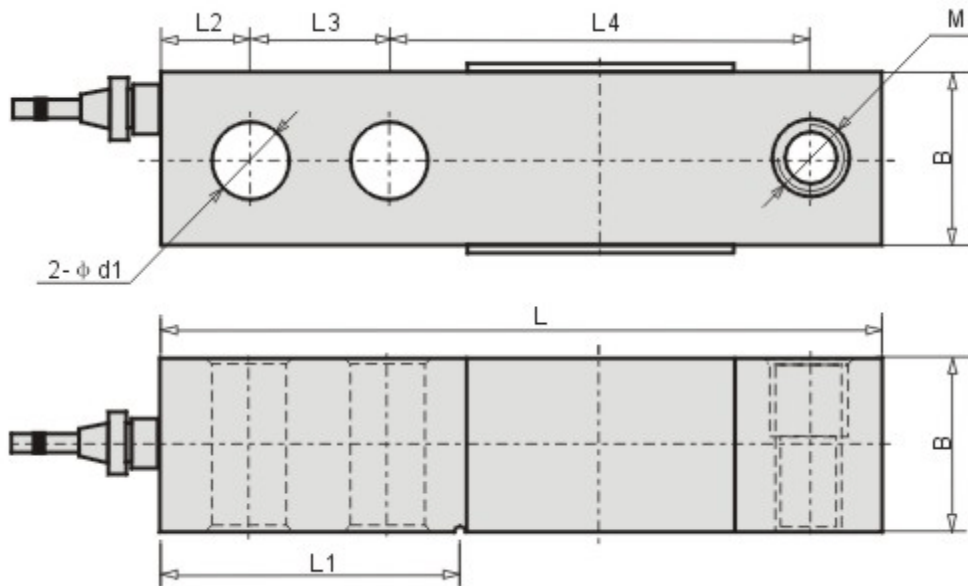

Компания СЭА
 Адрес: Украина, 02094, г. Киев, ул.Краковская, 13-Б,
 телефон: +38 (044) 291-00-41
 e-mail: info@sea.com.ua

| Capacity | L | L1 | L2 | L3 | L4 | d | B | M |
|----------------------|-------|-------|------|------|-------|------|------|----------------------|
| 0.5-2.5(Klb)0.5~2(t) | 130 | 56.5 | 15.8 | 25.4 | 76.2 | 13.5 | 31.8 | M12X1.75 M16X1.25 |
| 5~10(klb) 2.5~5(t) | 171.5 | 77.2 | 19.1 | 38.1 | 95.3 | 20 | 38.1 | M18X1.5 |
| 15,20(klb) 7.5,10(t) | 222.3 | 101.6 | 25.4 | 50.8 | 120.7 | 26.2 | 50.8 | M24x2 |

PARAMETERS:

| | |
|----------------------------------------|-----------------------------------------------------------------|
| Precision: 0.02%F.S | Insulation resistance: $\geq 5000\text{M}\Omega(100\text{VDC})$ |
| Rated output: $3\pm 0.003\text{ mv/v}$ | Excitation voltage: 9~12VDC |
| Non-linearity: 0.02%F.S | Compensated temp.range: -10~+40°C |
| Hysteresis: 0.02%F.S | Use temp.range: -20~+55°C |
| Repeatary: 0.02%F.S | Temp.effect on zero: 0.03F.S/10°C |
| Creep: 0.02%F.S/10min | Temp.effect on span: 0.02F.S/10°C |
| Zero balance: $\pm 1\%F.S$ | Safe overload: 120% |
| Input resistance: $350\pm 5\Omega$ | Ultimate overload: 150% |
| Output resistance: $350\pm 3\Omega$ | Defend grade: IP67 |

